

LBB 12 UU IKO

Linear bushing

TYPE: Shaft guidance systems, Linear bushing, Standard, Close type, Type LBB..UU, sealed on both sides, inch

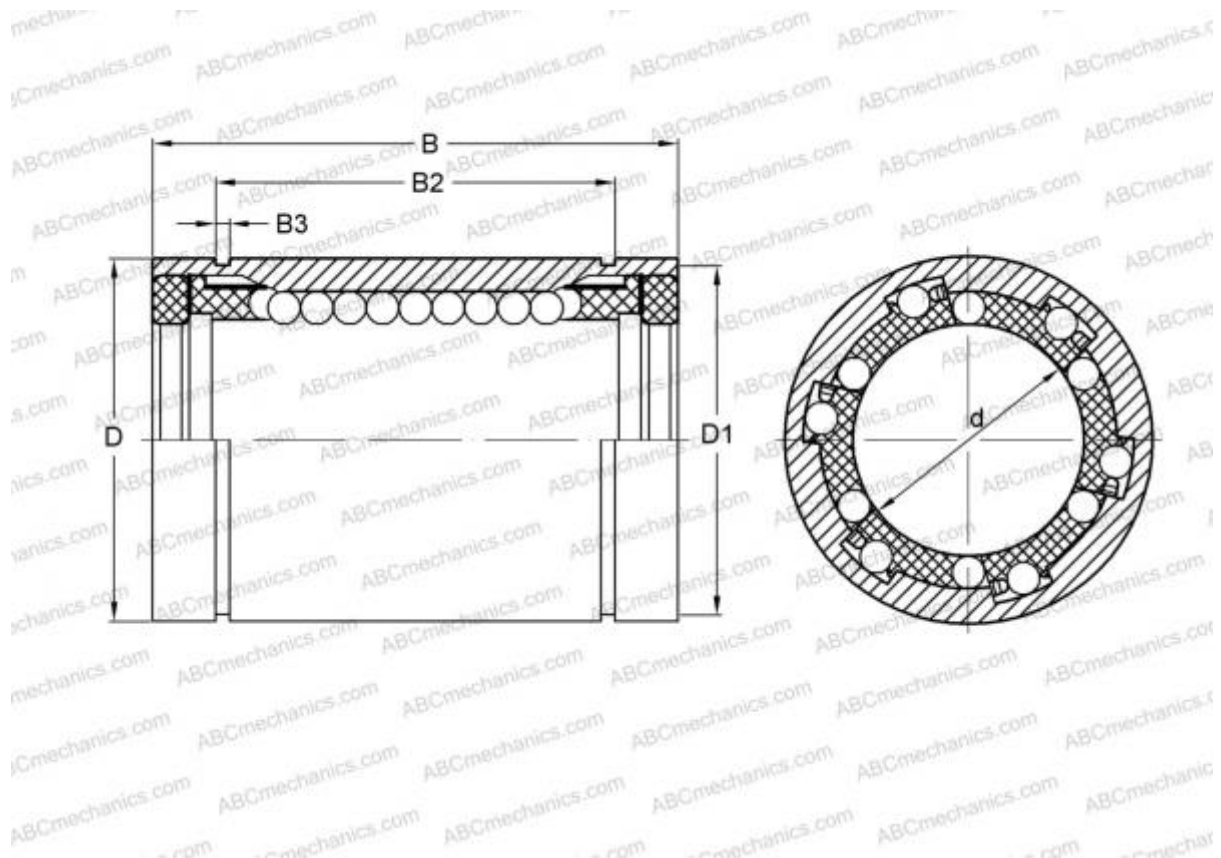

Technical specification

DIMENSIONS, MM

d	19,050
D	31,750
B	41,275

WEIGHT, KG 0,080

MANUFACTURER [IKO](#)

INTERCHANGE

ABC	LBB 12 UU
HEIM	LBB-750 PP

CALCULATION DATA

Basic dynamic load rating min	0,608 kN
Basic dynamic load rating max	0,724 kN
Basic static load rating min	1,150 kN
Basic static load rating max	1,680 kN