

## LBB 24 UU IKO

Linear bushing

TYPE: Shaft guidance systems, Linear bushing, Standard, Close type, Type LBB..UU, sealed on both sides, inch

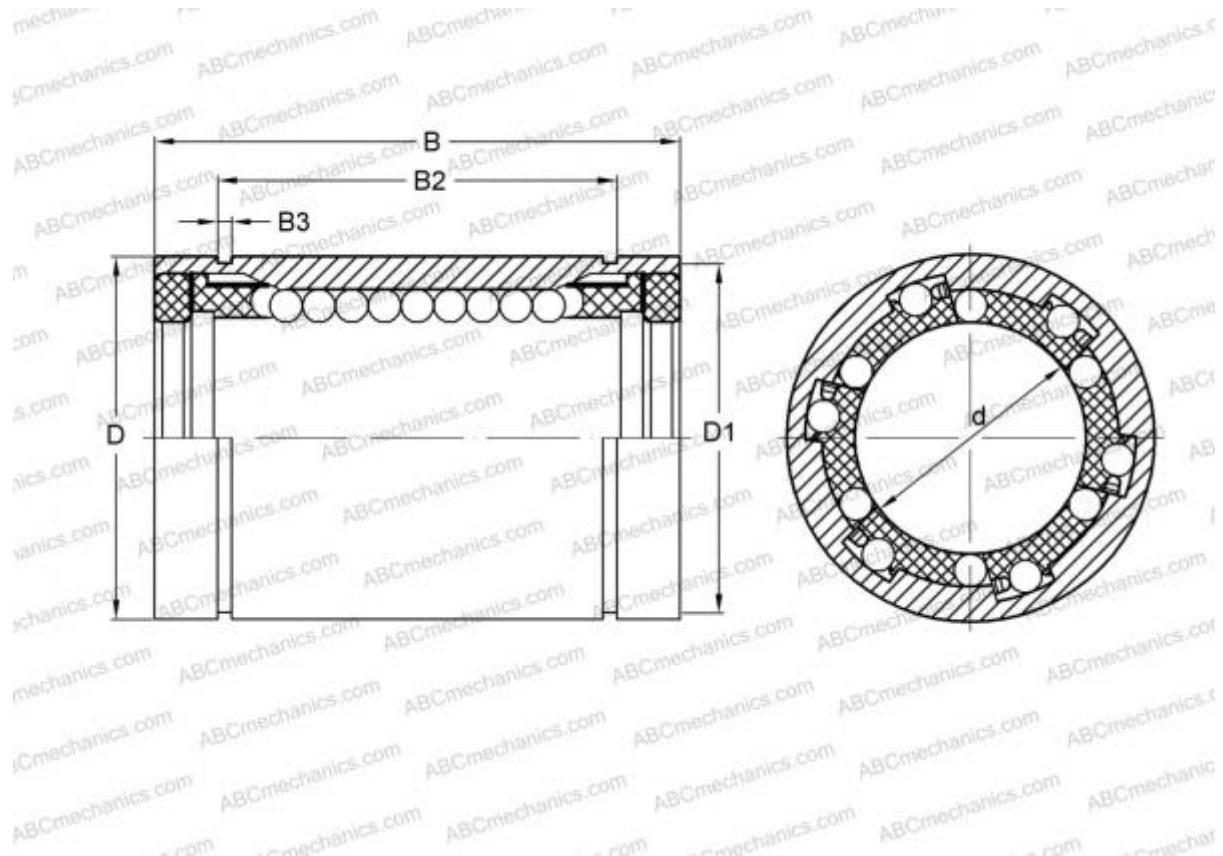

### Technical specification

#### DIMENSIONS, MM

d	38,100
D	60,325
B	76,200

**WEIGHT, KG** 0,535

**MANUFACTURER** [IKO](#)

#### INTERCHANGE

ABC	<a href="#">LBB 24 UU</a>
HEIM	<a href="#">LBB-1500 PP</a>

#### CALCULATION DATA

Basic dynamic load rating min	2,460 kN
Basic dynamic load rating max	2,610 kN
Basic static load rating min	4,330 kN
Basic static load rating max	5,540 kN