

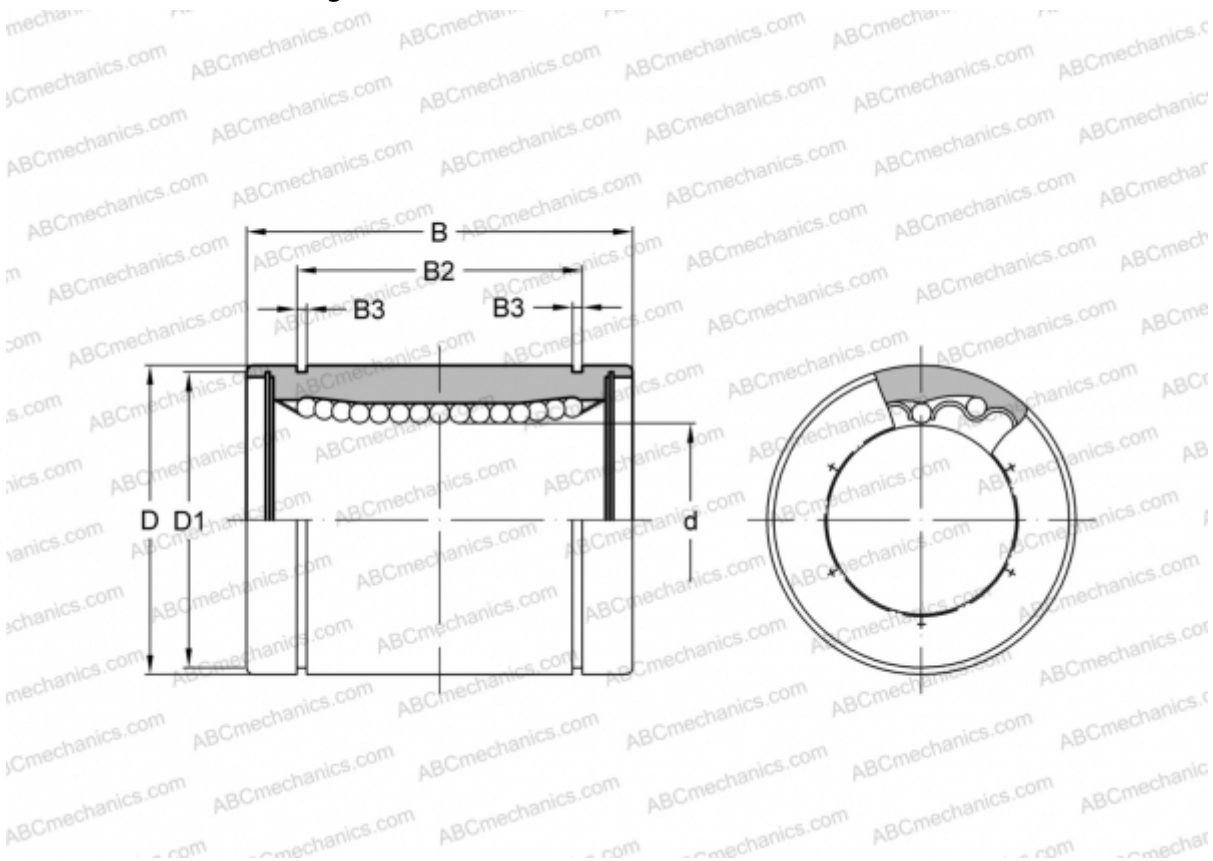

SMS 25G NB

Linear bushing

TYPE: Shaft guidance systems, Linear bushing, Standard, Close type, Type SM, Asian standard, Corrosion resistance, Plastic cage (NB)



Technical specification

DIMENSIONS, MM	
d	25,000
D	40,000
B	59,000
D1	38,000
B2	41,000
B3	1,850
WEIGHT, KG	
	0,240
MANUFACTURER	
	NB

