

LBB 20 UU AJ IKO

Linear bushing

TYPE: Shaft guidance systems, Linear bushing, Standard, Adjustable type, Type LBB..UU AJ, sealed on both sides, inch

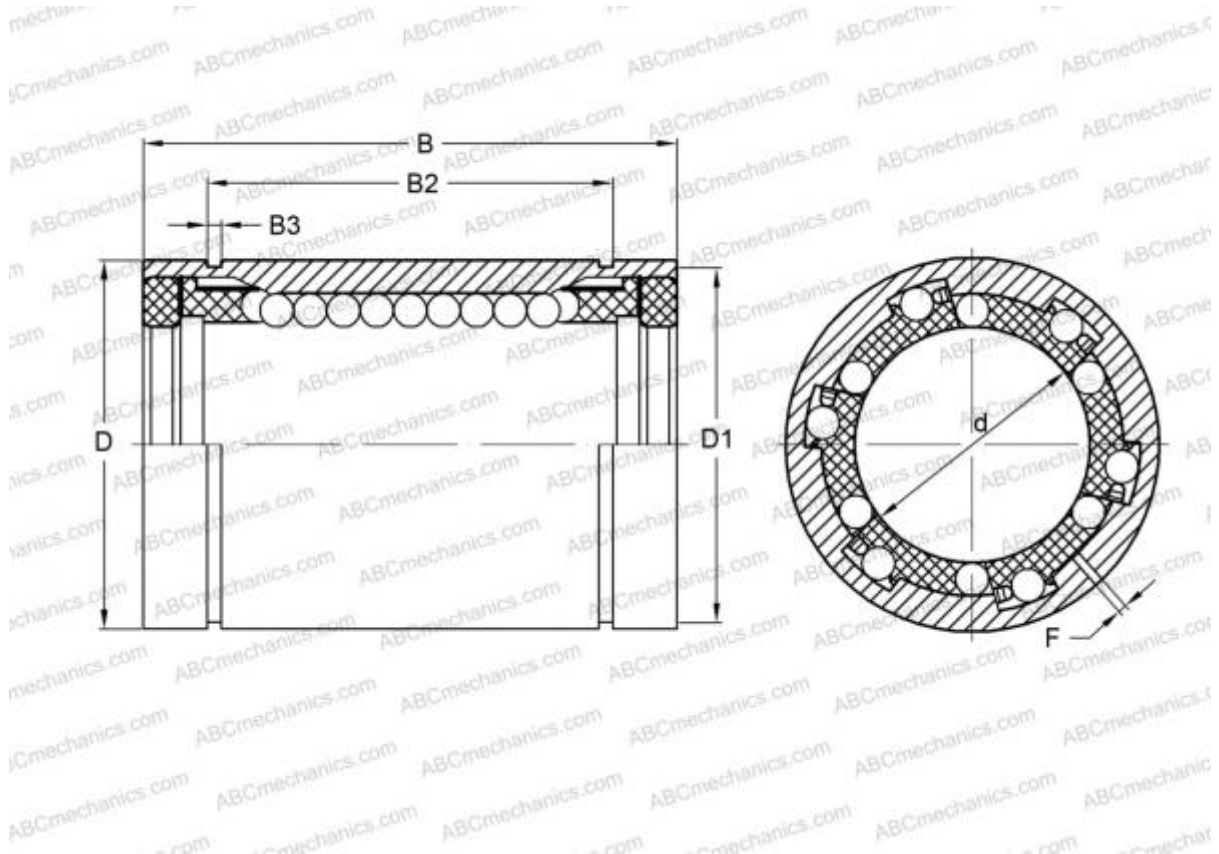

Technical specification

DIMENSIONS, MM

d	31,750
D	50,800
B	66,675
f	2,381

WEIGHT, KG 0,320

MANUFACTURER [IKO](#)

INTERCHANGE

ABC	LBB 20 UU AJ
HEIM	ADJ-1250 PP

CALCULATION DATA

Basic dynamic load rating min	1,920 kN
Basic dynamic load rating max	2,030 kN
Basic static load rating min	3,570 kN

CALCULATION DATA

Basic static load rating max	4,570 kN
------------------------------	----------