

## SMS 20-AJ NB

Linear bushing

TYPE: Shaft guidance systems, Linear bushing, Standard, Adjustable type, Type SM..AJ, Asian standard, Corrosion resistance, Stainless steel cage (NB)

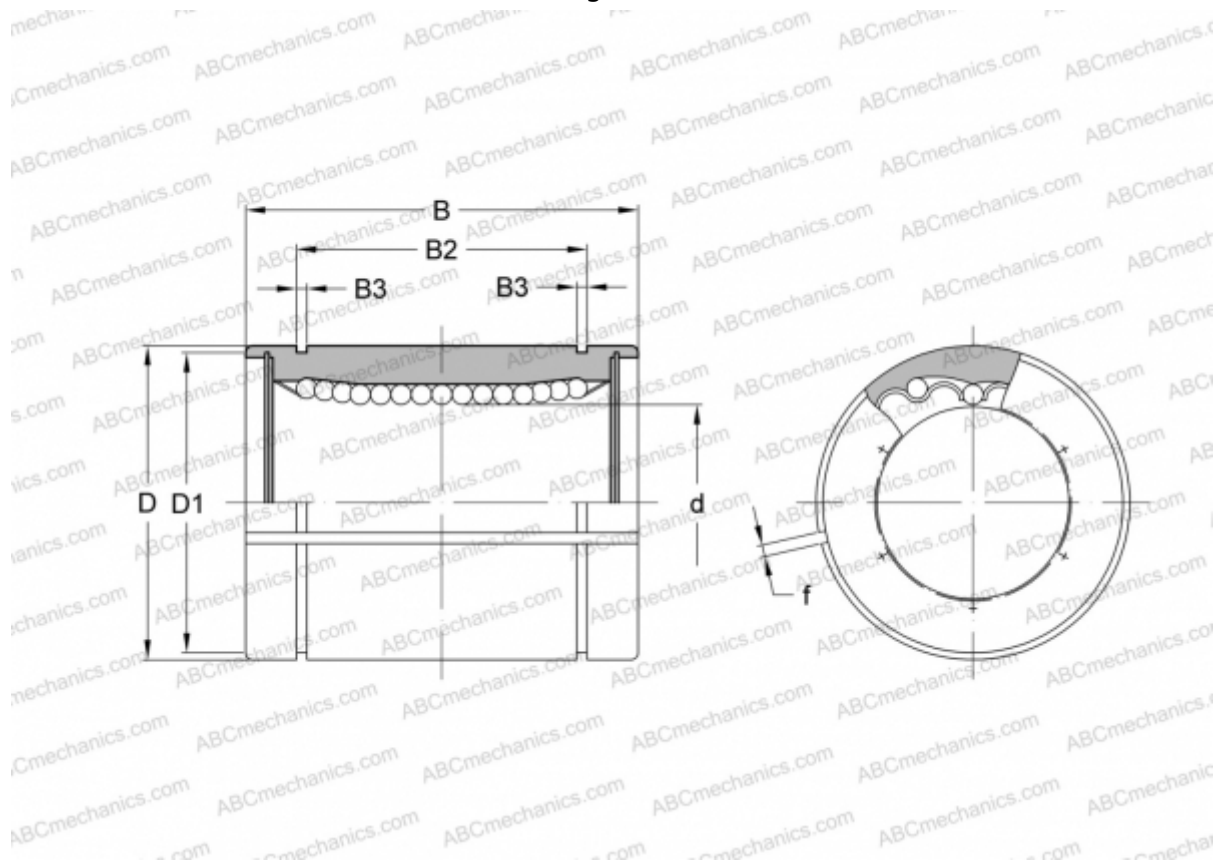

### Technical specification

#### DIMENSIONS, MM

d	20,000
D	32,000
B	42,000
D1	30,500
B2	30,500
B3	1,600
f	1,500

**WEIGHT, KG** 0,098

**MANUFACTURER** [NB](#)