

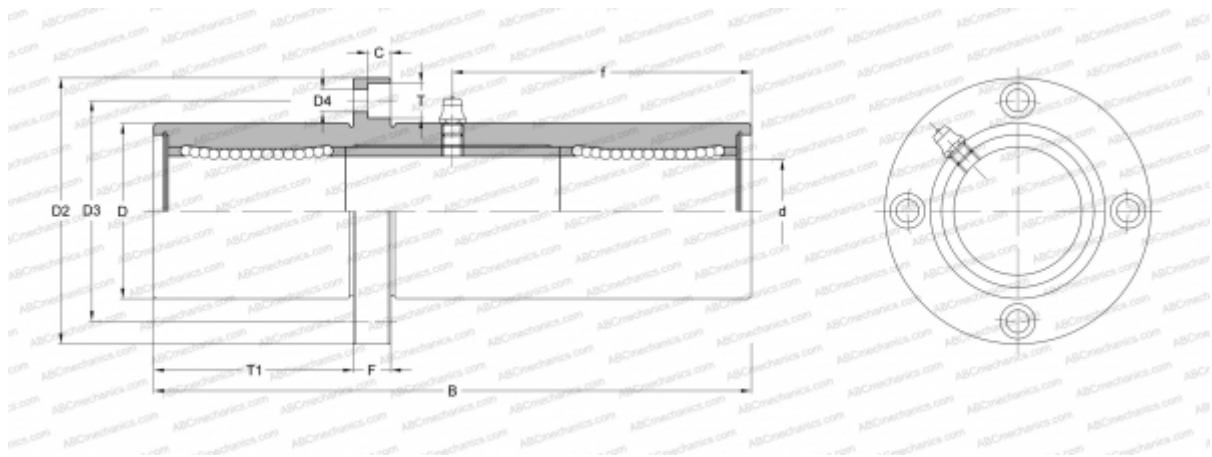

## TRFC 1SGUU NB

Linear bushing

TYPE: Shaft guidance systems, Linear bushing, Pilot flange location, Circular type, three length, Type TRFC, Asian standard, Plastic cage (NB)



### Technical specification

#### DIMENSIONS, MM

d	16,000
D	32,000
B	103,000
D2	54,000
D3	43,000
D4	5,500
T	9,000
T1	35,000
f	51,000
C	5,100
F	8

**WEIGHT, KG** 0,412

**MANUFACTURER** [NB](#)

