

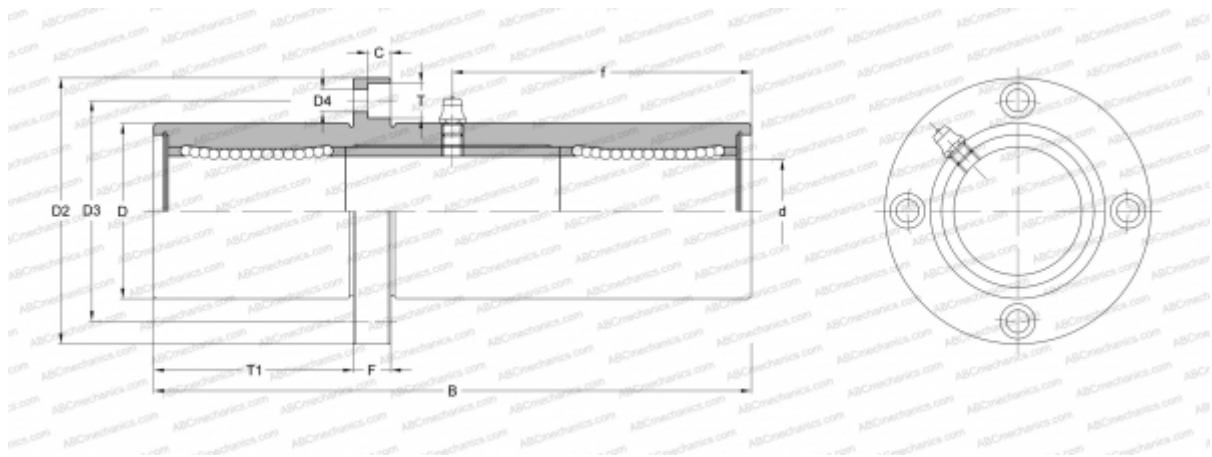

## TRFC 20GUU NB

Linear bushing

TYPE: Shaft guidance systems, Linear bushing, Pilot flange location, Circular type, three length, Type TRFC, Asian standard, Plastic cage (NB)



### Technical specification

#### DIMENSIONS, MM

d	20,000
D	40,000
B	118,000
D2	62,000
D3	51,000
D4	5,500
T	9,000
T1	40,000
f	59,000
C	5,100
F	8

**WEIGHT, KG** 0,752

**MANUFACTURER** [NB](#)

