

TRFC 50GUU NB

Linear bushing

TYPE: Shaft guidance systems, Linear bushing, Pilot flange location, Circular type, three length, Type TRFC, Asian standard, Plastic cage (NB)

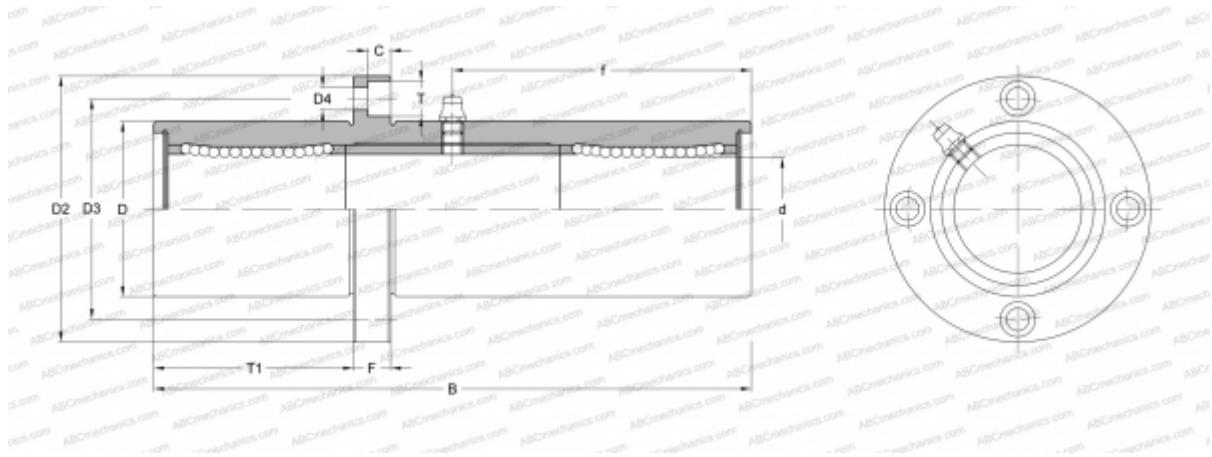

Technical specification

DIMENSIONS, MM

d	50,000
D	85,000
B	290,000
D2	129,000
D3	107,000
D4	11,000
T	17,000
T1	97,000
f	145,000
C	11,100
F	18

WEIGHT, KG 6,860

MANUFACTURER [NB](#)