

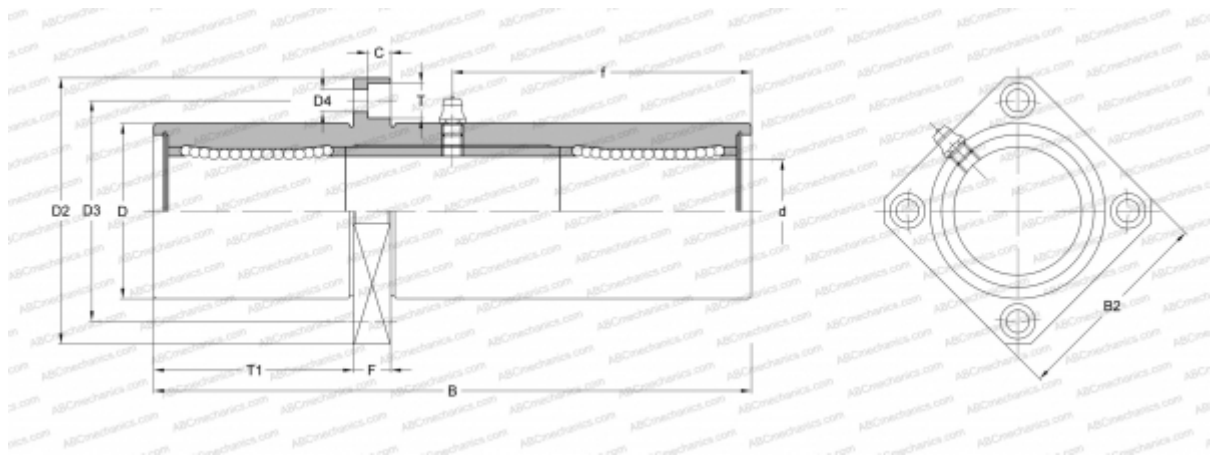

TRKC 6UU NB

Linear bushing

TYPE: Shaft guidance systems, Linear bushing, Pilot flange location, Square type, three length, Type TRKC, Asian standard, Steel cage (NB)



Technical specification

DIMENSIONS, MM

d	6,000
D	15,000
B	51,000
D2	32,000
D3	24,000
D4	3,500
B2	25,000
T	6,000
T1	17,000
f	20,500
C	3,100
F	5

WEIGHT, KG 0,058

MANUFACTURER [NB](#)

