

TRKC 10UU NB

Linear bushing

TYPE: Shaft guidance systems, Linear bushing, Pilot flange location, Square type, three length, Type TRKC, Asian standard, Steel cage (NB)

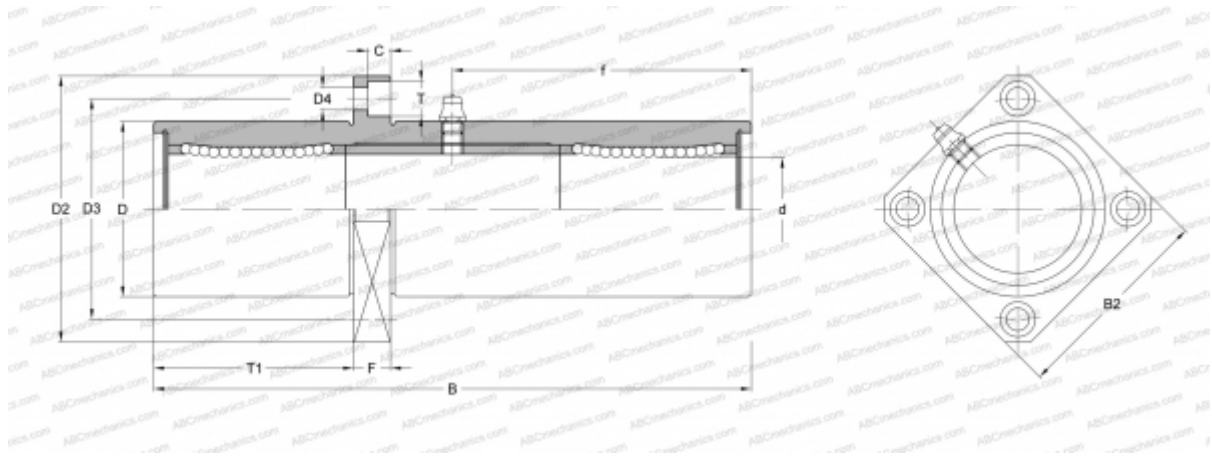

Technical specification

DIMENSIONS, MM

d	10,000
D	23,000
B	80,000
D2	43,000
D3	33,000
D4	4,500
B2	34,000
T	7,500
T1	27,000
f	38,000
C	4,100
F	6

WEIGHT, KG 0,189

MANUFACTURER [NB](#)