

TRF 60GUU-E NB

Linear bushing

TYPE: Shaft guidance systems, Linear bushing, Pilot flange location, Circular type, three length, Type TRF..E, Asian standard, Plastic cage (NB)

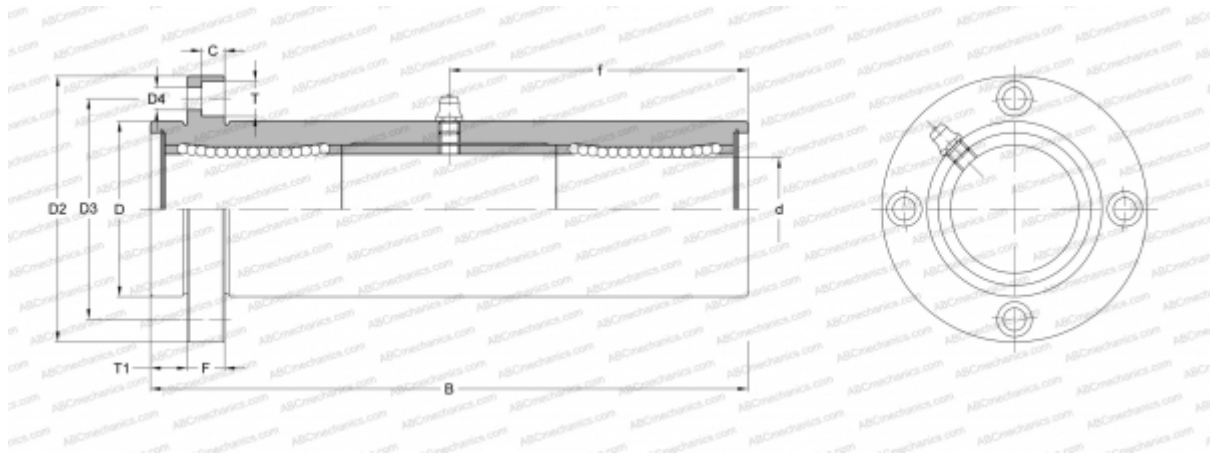

Technical specification

DIMENSIONS, MM

d	60,000
D	100,000
B	310,000
D2	144,000
D3	122,000
D4	11,000
T	17,000
T1	18,000
f	155,000
C	11,100
F	18

WEIGHT, KG 9,660

MANUFACTURER [NB](#)