

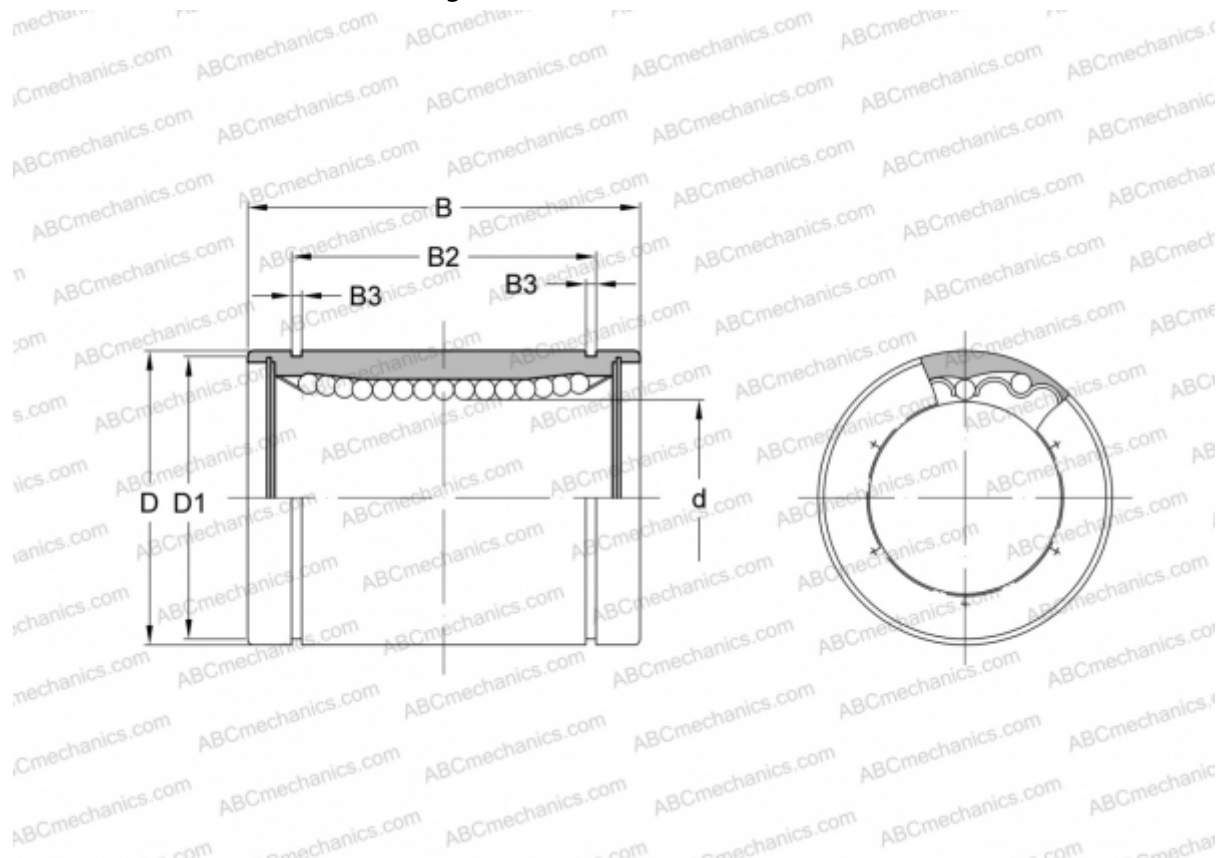

## KBS 3 NB

Linear bushing

TYPE: Shaft guidance systems, Linear bushing, Standard, Close type, Type KB, European standard, Corrosion resistance, Stainless steel cage (NB)



### Technical specification

#### DIMENSIONS, MM

d	3,000
D	7,000
B	10,000

WEIGHT, KG 0,001

MANUFACTURER [NB](#)

