

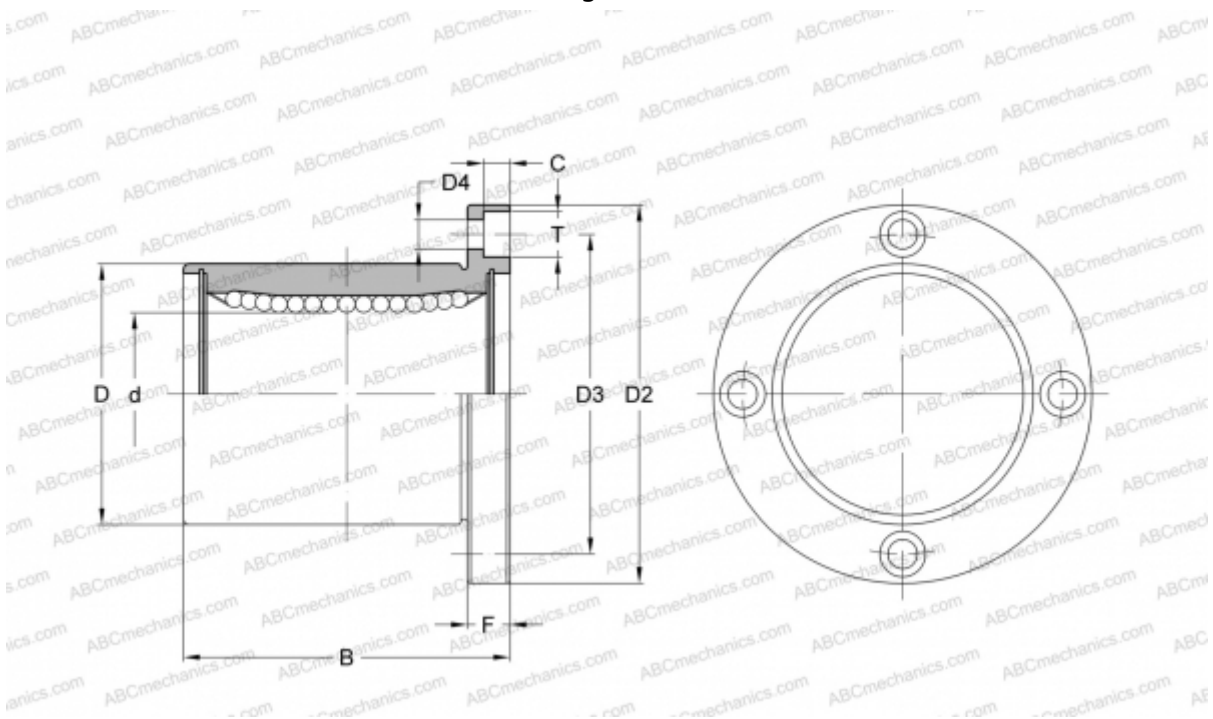

KBSF 12 NB

Linear bushing

TYPE: Shaft guidance systems, Linear bushing, With flange, Circular type, Type KBF, European standard, Corrosion resistance, Stainless steel cage (NB)



Technical specification

DIMENSIONS, MM	
d	12,000
D	22,000
B	32,000
D2	42,000
D3	32,000
F	6
WEIGHT, KG	
0,080	
MANUFACTURER	
NB	

