

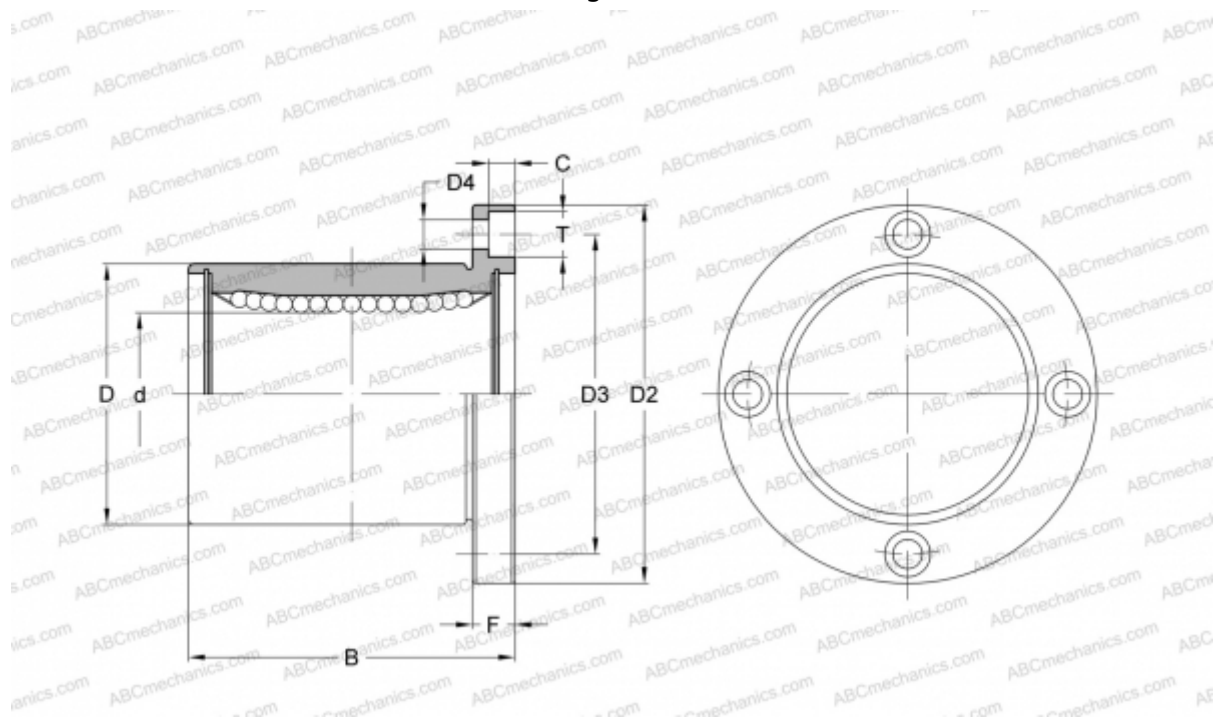

## KBSF 20 NB

Linear bushing

TYPE: Shaft guidance systems, Linear bushing, With flange, Circular type, Type KBF, European standard, Corrosion resistance, Stainless steel cage (NB)



### Technical specification

#### DIMENSIONS, MM

d	20,000
D	32,000
B	45,000
D2	54,000
D3	43,000
F	8

**WEIGHT, KG** 0,182

**MANUFACTURER** [NB](#)

