

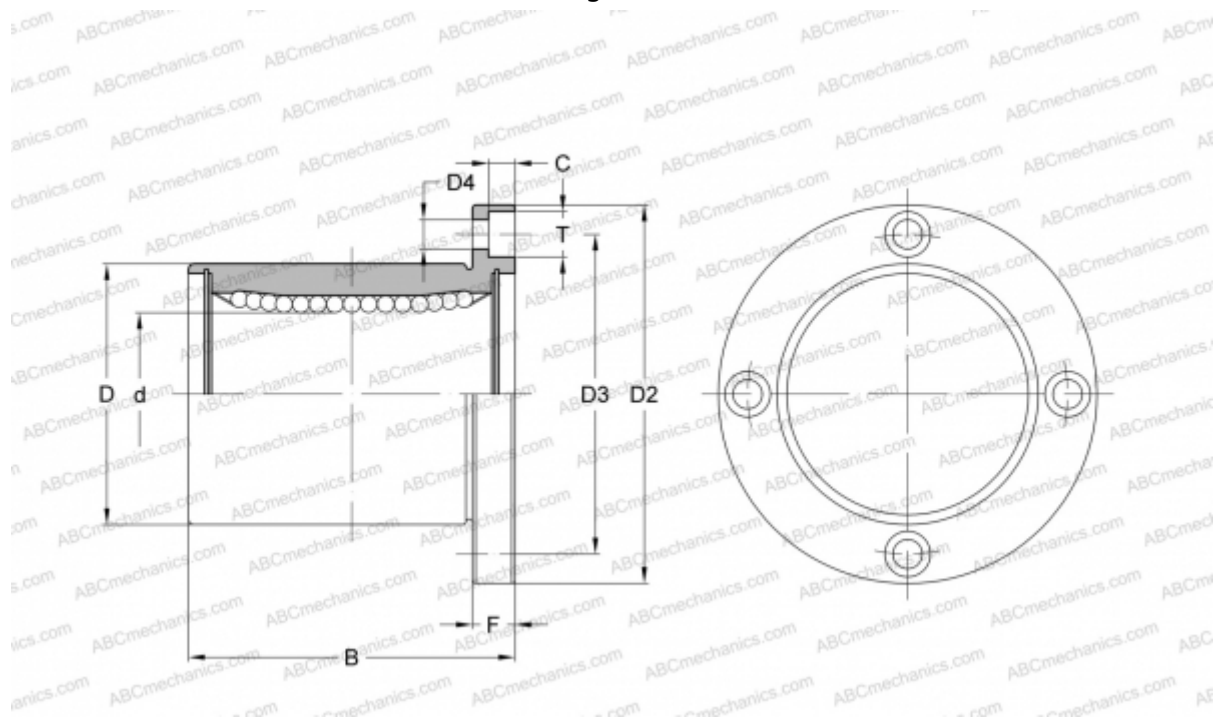

## KBSF 40 NB

Linear bushing

TYPE: Shaft guidance systems, Linear bushing, With flange, Circular type, Type KBF, European standard, Corrosion resistance, Stainless steel cage (NB)



### Technical specification

#### DIMENSIONS, MM

d	40,000
D	62,000
B	80,000
D2	98,000
D3	80,000
F	13

**WEIGHT, KG** 1,175

**MANUFACTURER** [NB](#)

