

GM 25 NB

Linear bushing

TYPE: Shaft guidance systems, Linear bushing, Standard, Close type, Type GM (NB)

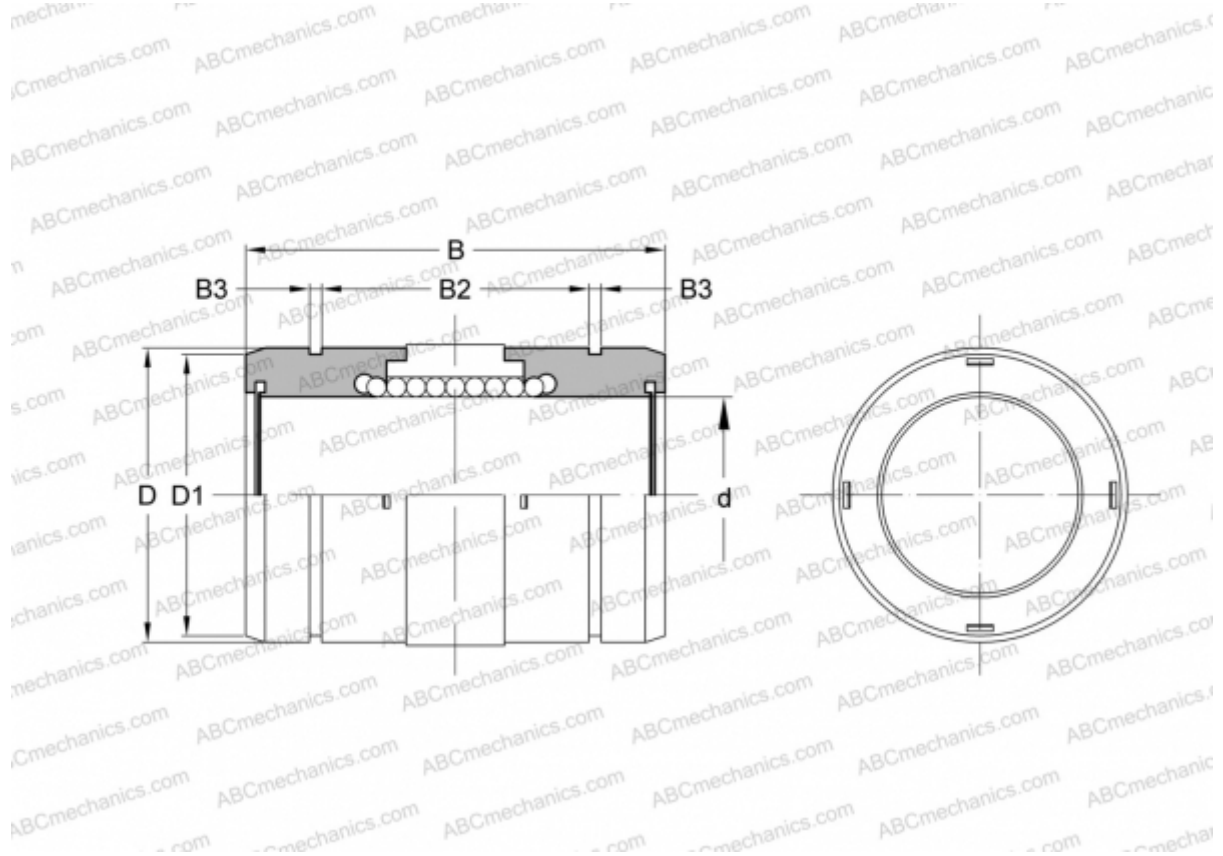

Technical specification

DIMENSIONS, MM

d	25,000
D	40,000
B	59,000
D1	38,000
B2	37,300
B3	1,850

WEIGHT, KG 0,150

MANUFACTURER [NB](#)