

GM 6W UU NB

Linear bushing

TYPE: Shaft guidance systems, Linear bushing, Standard, Close type, double length, Type GM..W (NB)

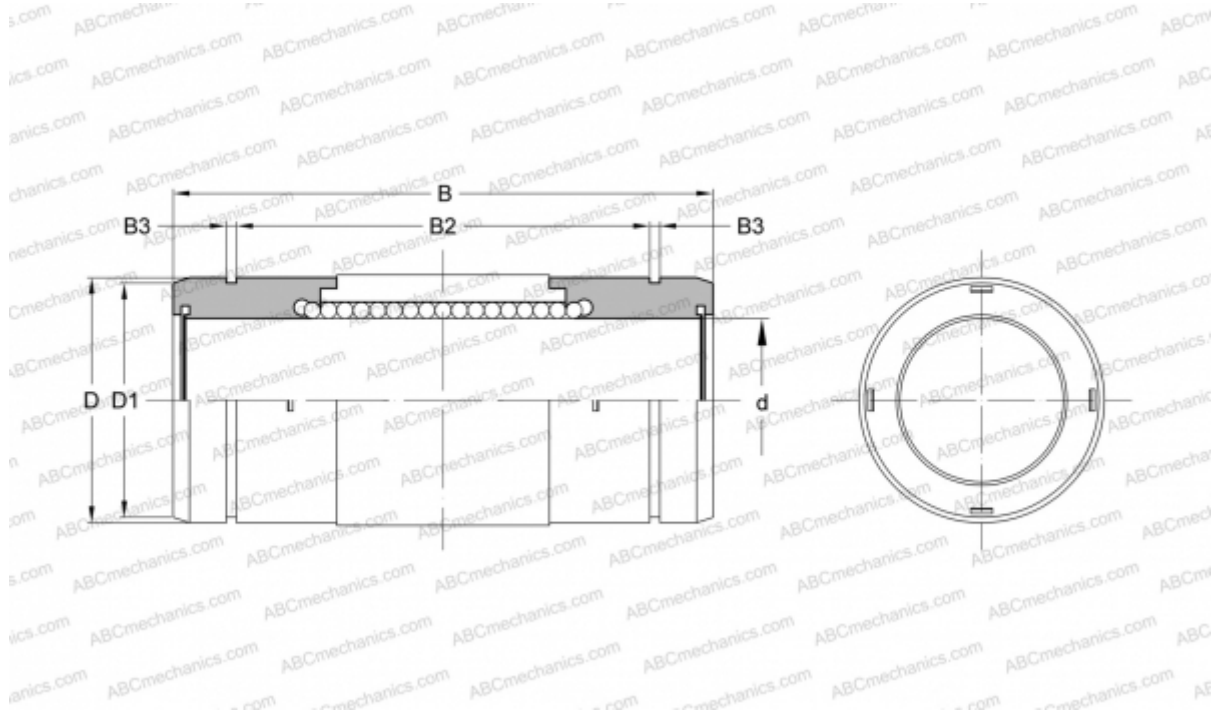

Technical specification

DIMENSIONS, MM

d	6,000
D	12,000
B	28,000
D1	11,500
B2	20,300
B3	1,100

WEIGHT, KG 0,009

MANUFACTURER [NB](#)