

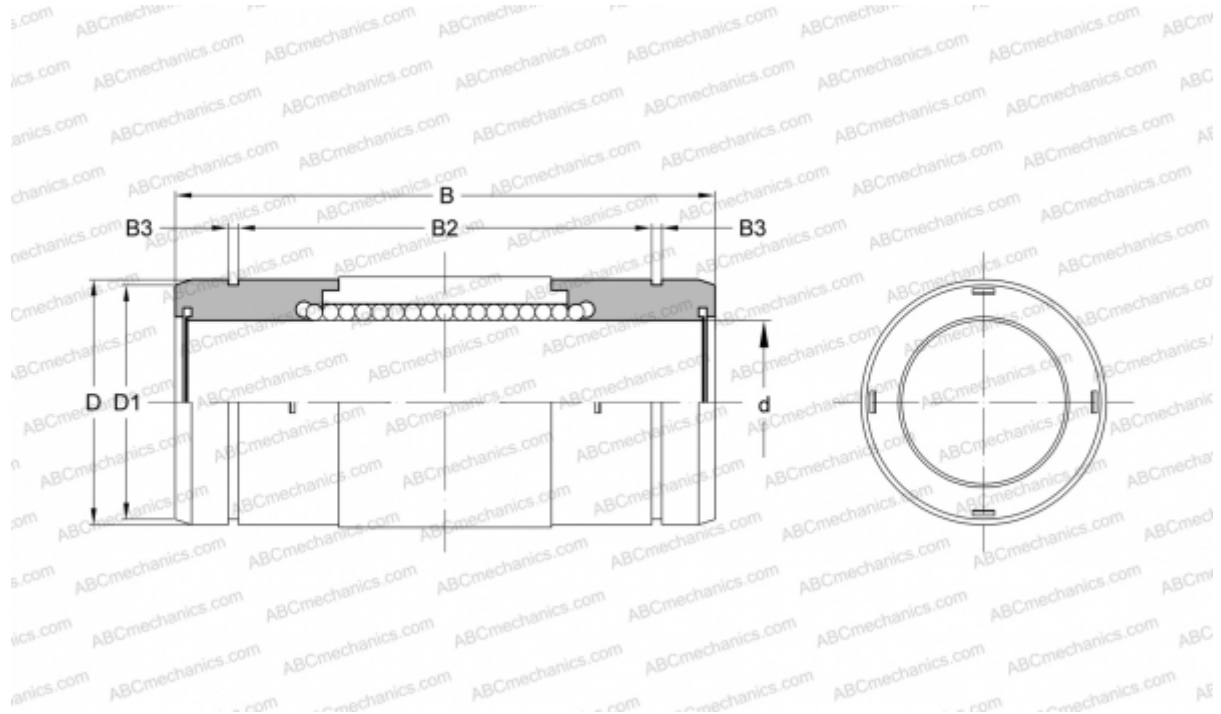

GM 12W UU NB

Linear bushing

TYPE: Shaft guidance systems, Linear bushing, Standard, Close type, double length, Type GM..W (NB)



Technical specification

DIMENSIONS, MM

d	12,000
D	21,000
B	46,000
D1	20,000
B2	36,400
B3	1,300

WEIGHT, KG 0,042

MANUFACTURER [NB](#)

