

GM 16W UU NB

Linear bushing

TYPE: Shaft guidance systems, Linear bushing, Standard, Close type, double length, Type GM..W (NB)

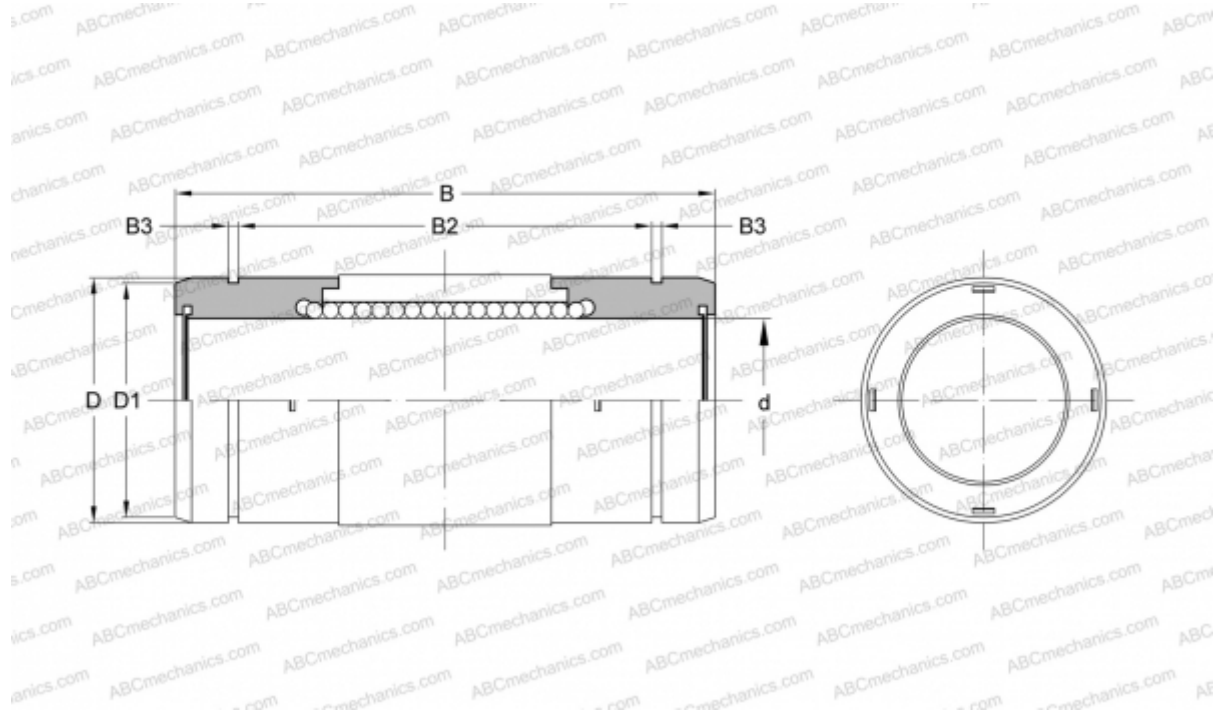

Technical specification

DIMENSIONS, MM

d	16,000
D	28,000
B	53,000
D1	27,000
B2	39,300
B3	1,600

WEIGHT, KG 0,076

MANUFACTURER [NB](#)