

GM 20W UU NB

Linear bushing

TYPE: Shaft guidance systems, Linear bushing, Standard, Close type, double length, Type GM..W (NB)

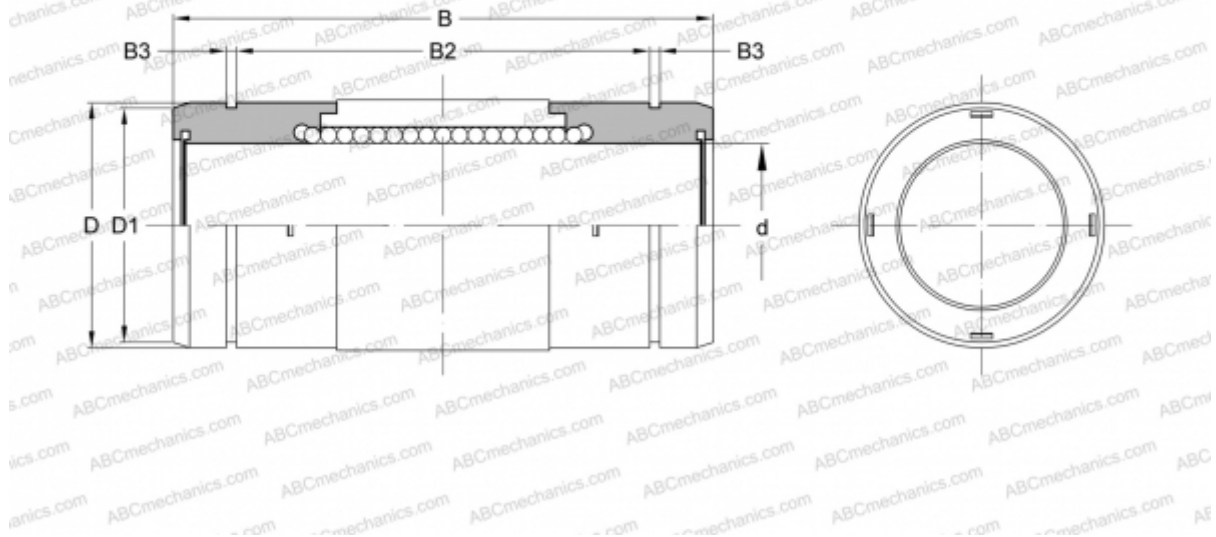

Technical specification

DIMENSIONS, MM

d	20,000
D	32,000
B	65,000
D1	30,500
B2	50,300
B3	1,600

WEIGHT, KG 0,130

MANUFACTURER [NB](#)