

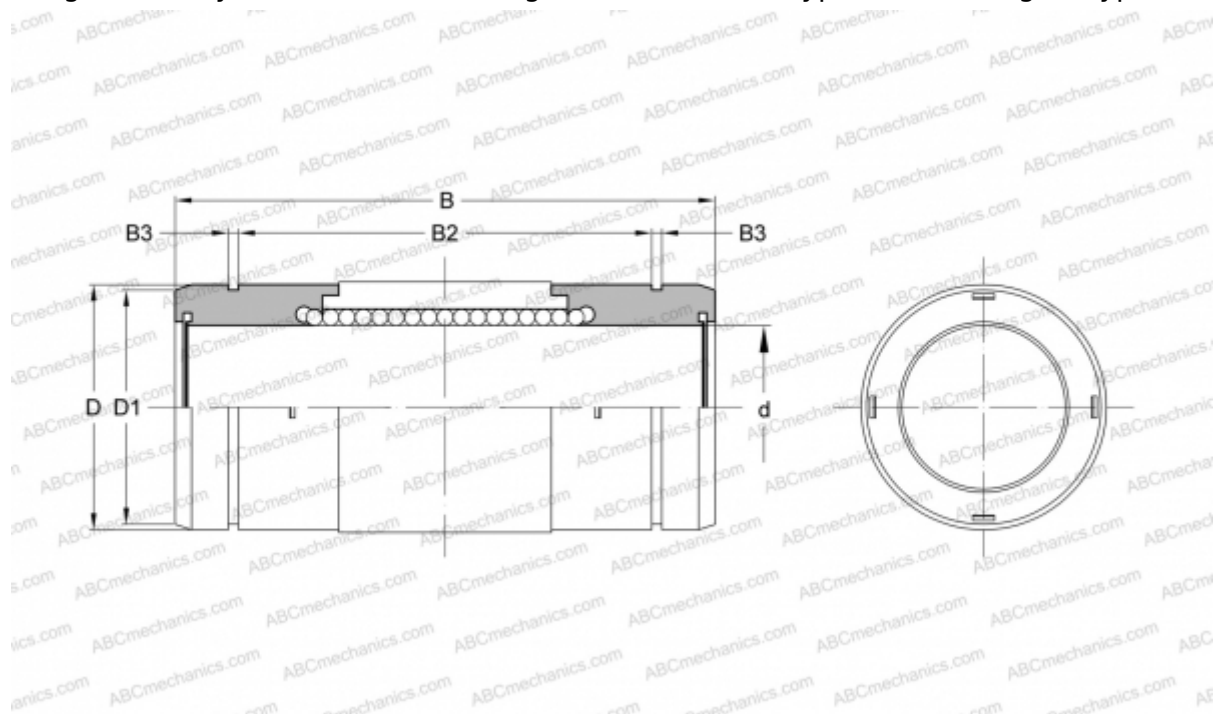

GM 25W UU NB

Linear bushing

TYPE: Shaft guidance systems, Linear bushing, Standard, Close type, double length, Type GM..W (NB)



Technical specification

DIMENSIONS, MM

d	25,000
D	40,000
B	91,000
D1	38,000
B2	69,300
B3	1,850

WEIGHT, KG 0,280

MANUFACTURER [NB](#)

