

LM20 UU A SAMICK

Linear bushing

TYPE: Shaft guidance systems, Linear bushing, Standard, Close type, Type LM, Asian standard, Steel cage (SAMICK)

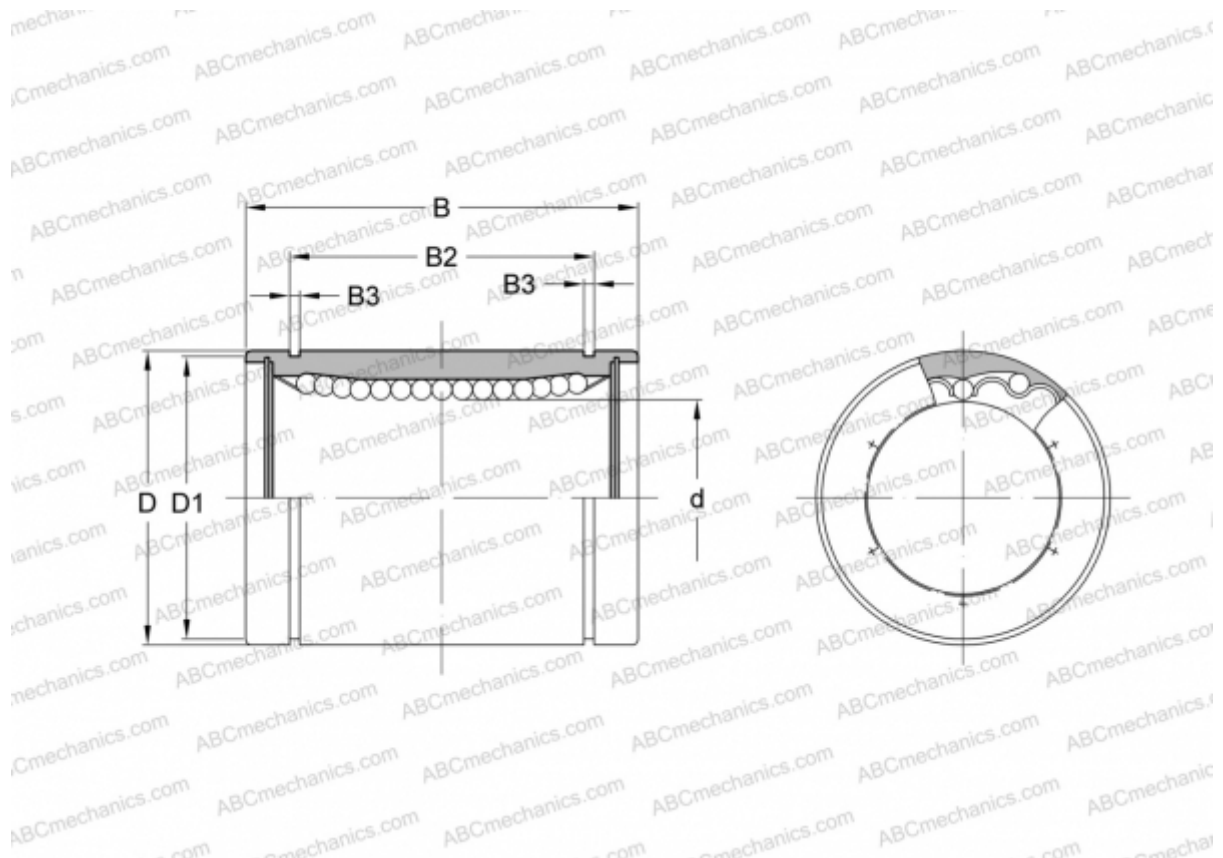

Technical specification

DIMENSIONS, MM

d	20,000
D	32,000
B	42,000
D1	30,500
B2	30,500
B3	1,600

WEIGHT, KG 0,087

MANUFACTURER [SAMICK](http://www.samick.com)