

SM20G-LUU NB

Linear bushing

TYPE: Shaft guidance systems, Linear bushing, Standard, Close type, Type SM..G-L, long (NB)

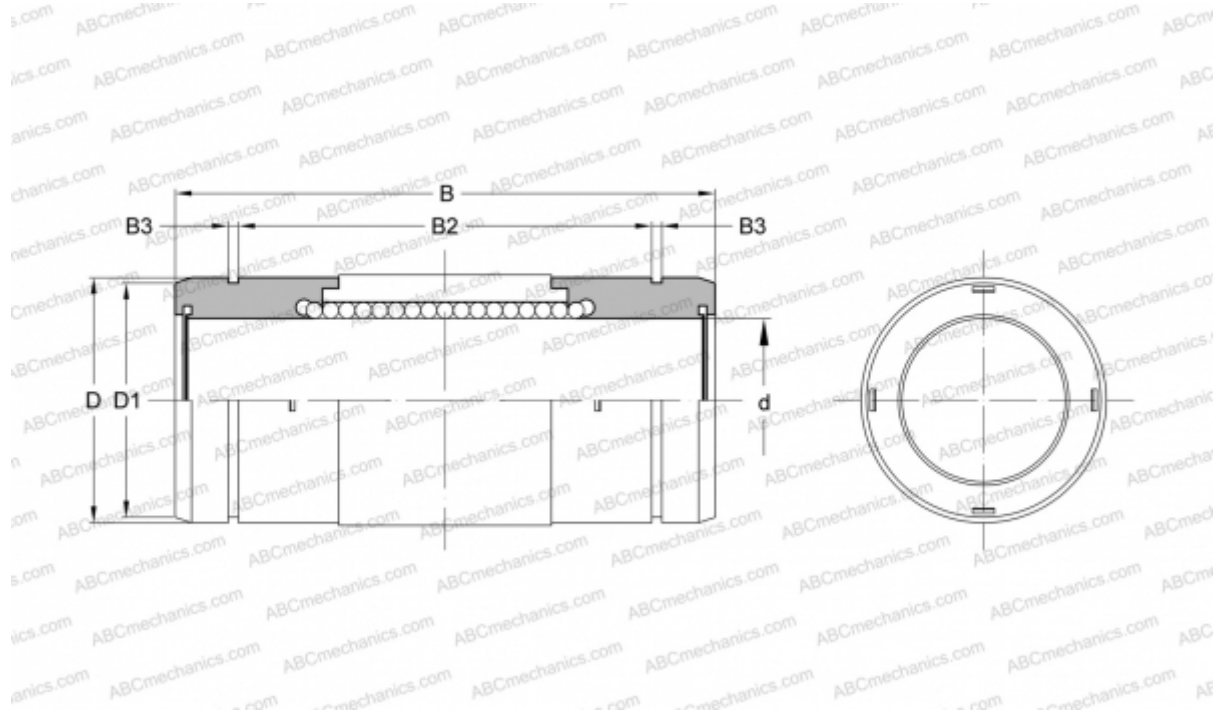

Technical specification

DIMENSIONS, MM

d	20,000
D	32,000
B	59,000
D1	30,500
B3	1,000

WEIGHT, KG 0,125

MANUFACTURER [NB](#)