

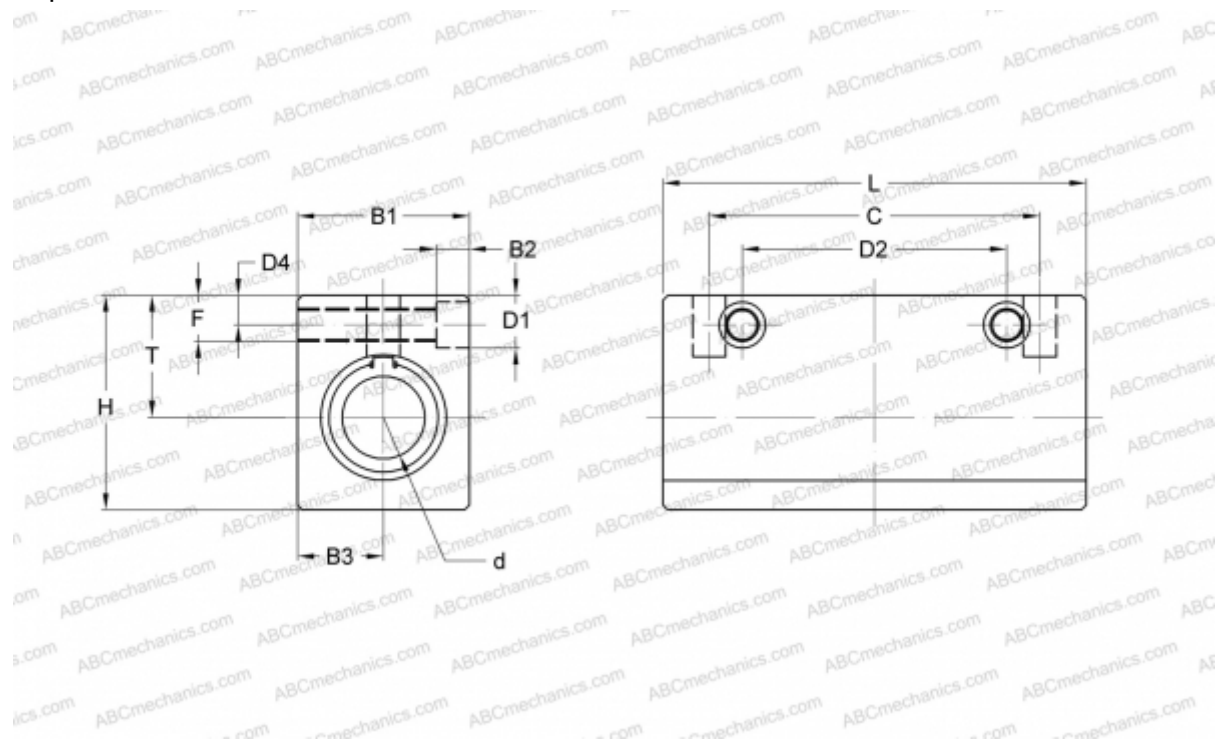

AK 6GWUU NB

Linear bushing, case unit

TYPE: Shaft guidance systems, Linear bushing, case unit, Close type, Double-wide block type, Type AK..W, compact (NB)



Technical specification

DIMENSIONS, MM

B1	16,000
H	22,000
L	46,000
d	6,000
D1	6,000
D2	30,000
D4	5,000
B2	5,000
B3	8,000
T	14,000
C	20,000
c	30
F	8

WEIGHT, KG 0,040

MANUFACTURER [NB](#)

