

## CR 99049 CR

Wear sleeves

TYPE: Wear sleeves, SKF Speedi-Sleeve, Speedi-Sleeve (SKF)

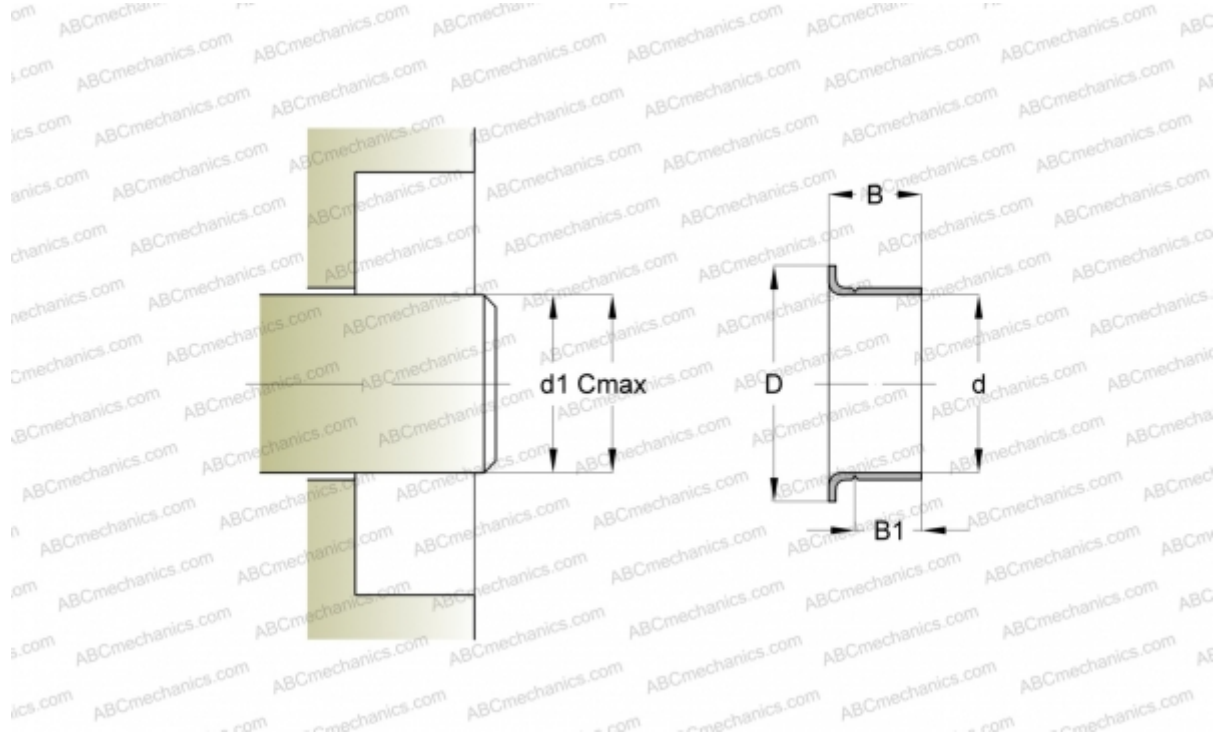

### Technical specification

#### DIMENSIONS, MM

d1	11,990
d	11,990
D	15,490
B	8,410
B1	5,990
C	12,070

**MANUFACTURER** [CR](#)

#### INTERCHANGE

SKF [99049](#)

#### CALCULATION DATA

Maximum shaft surface speed 0,001 m/s