

## CR 99050 CR

Wear sleeves

TYPE: Wear sleeves, SKF Speedi-Sleeve, Speedi-Sleeve (SKF)

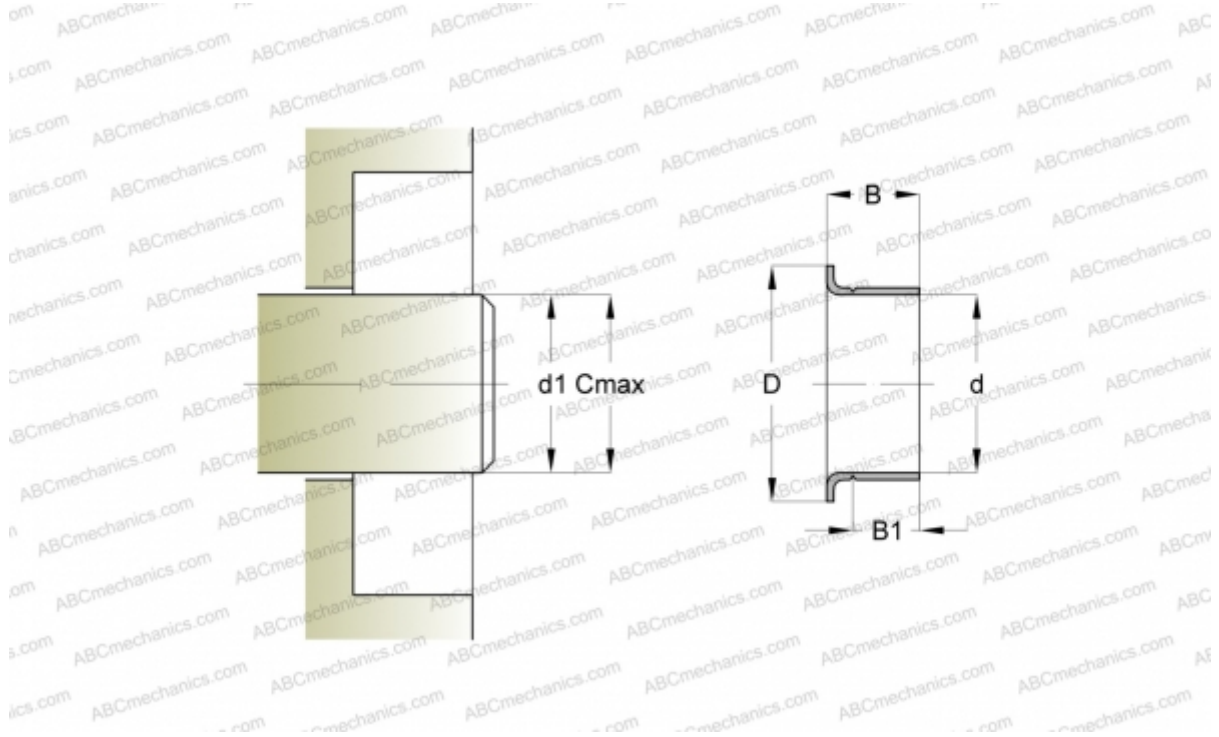

### Technical specification

#### DIMENSIONS, MM

d1	12,650
d	12,700
D	15,490
B	8,740
B1	6,350
C	12,750

**MANUFACTURER** [CR](#)

#### INTERCHANGE

SKF [99050](#)

#### CALCULATION DATA

Maximum shaft surface speed 0,001 m/s