

## 99056 SKF

Wear sleeves

TYPE: Wear sleeves, SKF Speedi-Sleeve, Speedi-Sleeve (SKF)

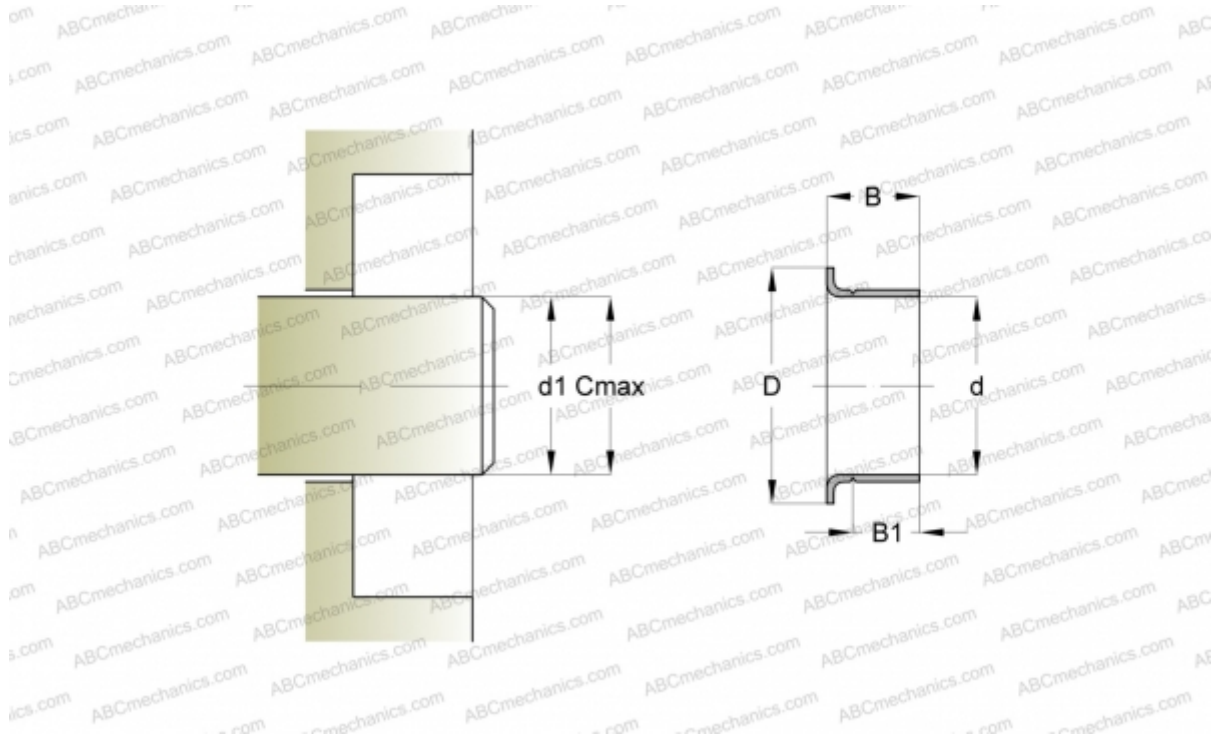

### Technical specification

#### DIMENSIONS, MM

d1	14,220
d	14,300
D	19,050
B	9,930
B1	6,350
C	14,380

**MANUFACTURER** [SKF](#)

#### INTERCHANGE

CR [CR 99056](#)

#### CALCULATION DATA

Maximum shaft surface speed 0,001 m/s