

CR 99056 CR

Wear sleeves

TYPE: Wear sleeves, SKF Speedi-Sleeve, Speedi-Sleeve (SKF)

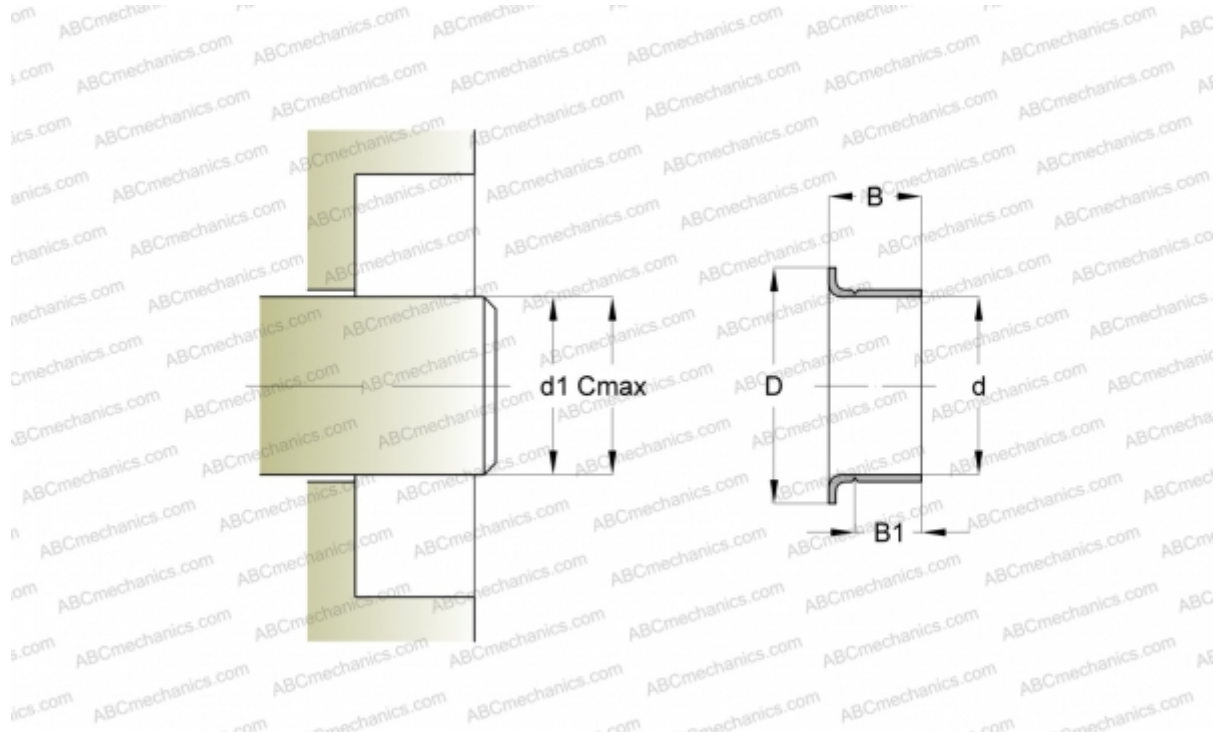

Technical specification

DIMENSIONS, MM

d1	14,220
d	14,300
D	19,050
B	9,930
B1	6,350
C	14,380

MANUFACTURER [CR](#)

INTERCHANGE

SKF	99056
-----	-----------------------

CALCULATION DATA

Maximum shaft surface speed	0,001 m/s
-----------------------------	-----------