

## CR 99058 CR

Wear sleeves

TYPE: Wear sleeves, SKF Speedi-Sleeve, Speedi-Sleeve (SKF)

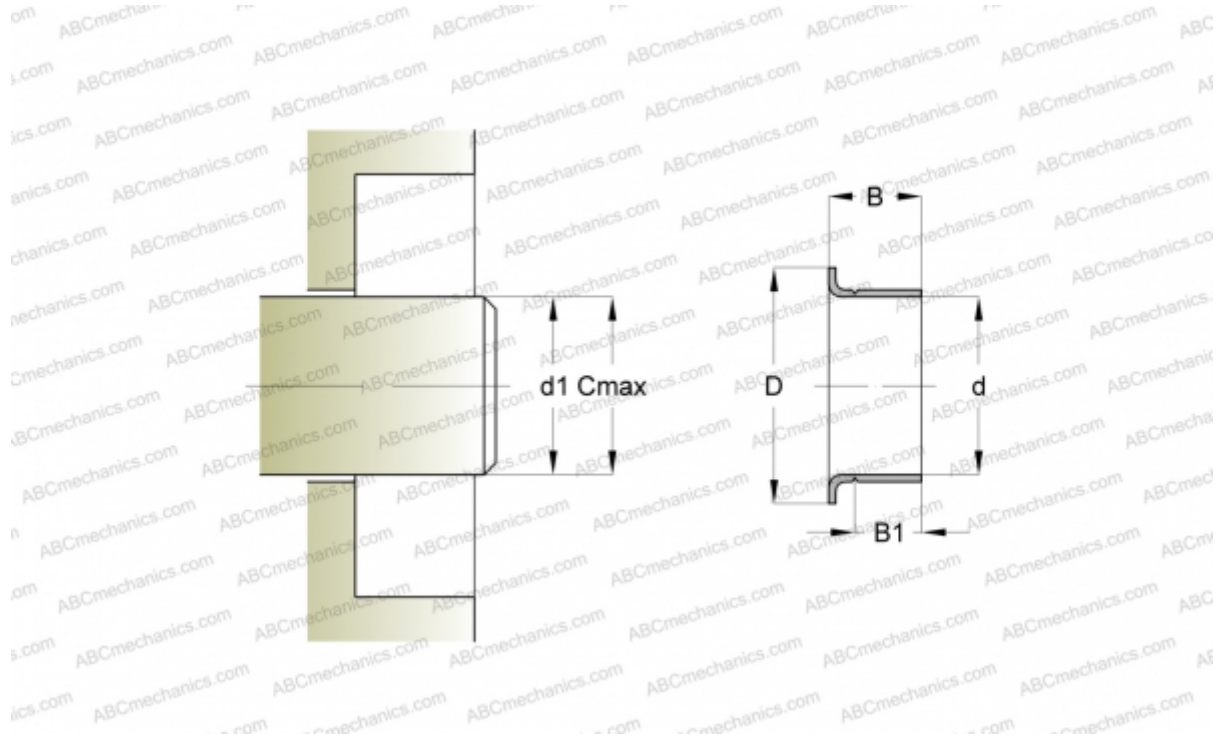

### Technical specification

#### DIMENSIONS, MM

d1	15,900
d	16,000
D	18,240
B	11,130
B1	7,950
C	16,000

**MANUFACTURER** [CR](#)

#### INTERCHANGE

SKF	<a href="#">99058</a>
-----	-----------------------

#### CALCULATION DATA

Maximum shaft surface speed	0,001 m/s
-----------------------------	-----------