

## CR 99060 CR

Wear sleeves

TYPE: Wear sleeves, SKF Speedi-Sleeve, Speedi-Sleeve (SKF)

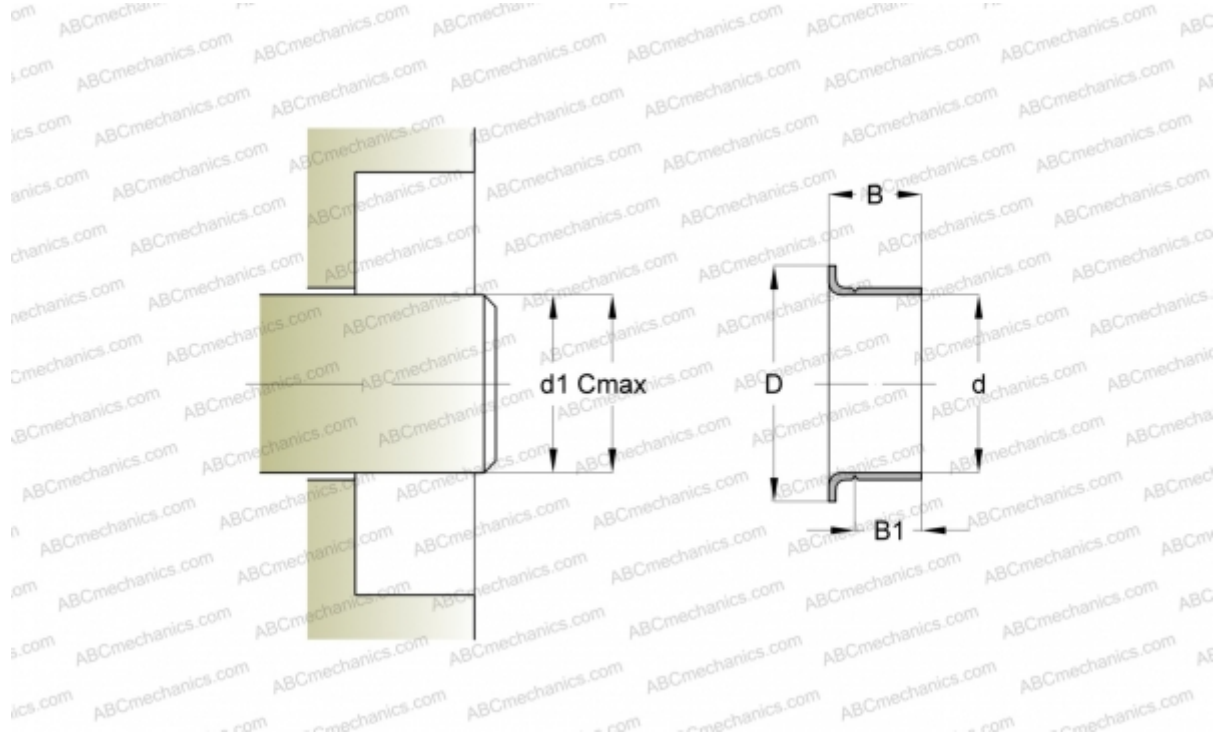

### Technical specification

#### DIMENSIONS, MM

|    |        |
|----|--------|
| d1 | 17,320 |
| d  | 17,370 |
| D  | 22,860 |
| B  | 11,130 |
| B1 | 7,950  |
| C  | 17,420 |

**MANUFACTURER** [CR](#)

#### INTERCHANGE

SKF [99060](#)

#### CALCULATION DATA

Maximum shaft surface speed 0,001 m/s