

## 99076 SKF

Wear sleeves

TYPE: Wear sleeves, SKF Speedi-Sleeve, Speedi-Sleeve (SKF)

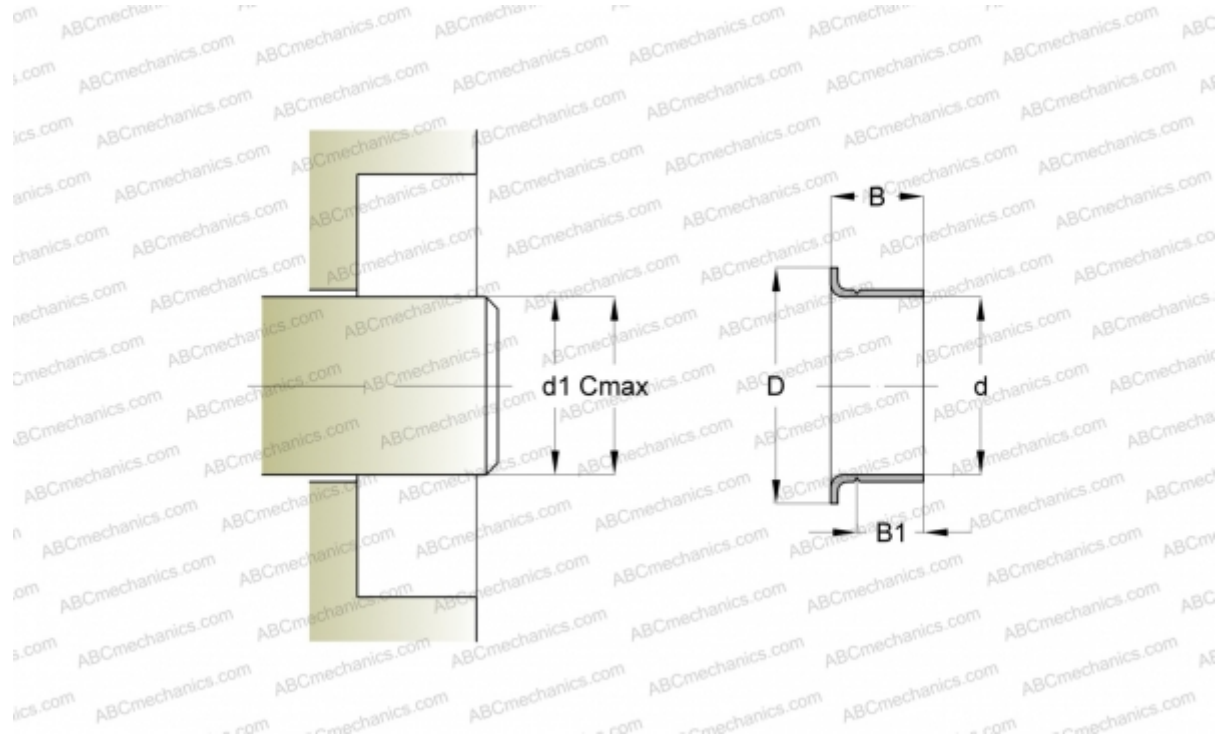

### Technical specification

#### DIMENSIONS, MM

d1	19,000
d	19,050
D	24,000
B	11,130
B1	7,950
C	19,100

**MANUFACTURER** [SKF](#)

#### INTERCHANGE

CR	<a href="#">CR 99076</a>
----	--------------------------

#### CALCULATION DATA

Maximum shaft surface speed	0,001 m/s
-----------------------------	-----------