

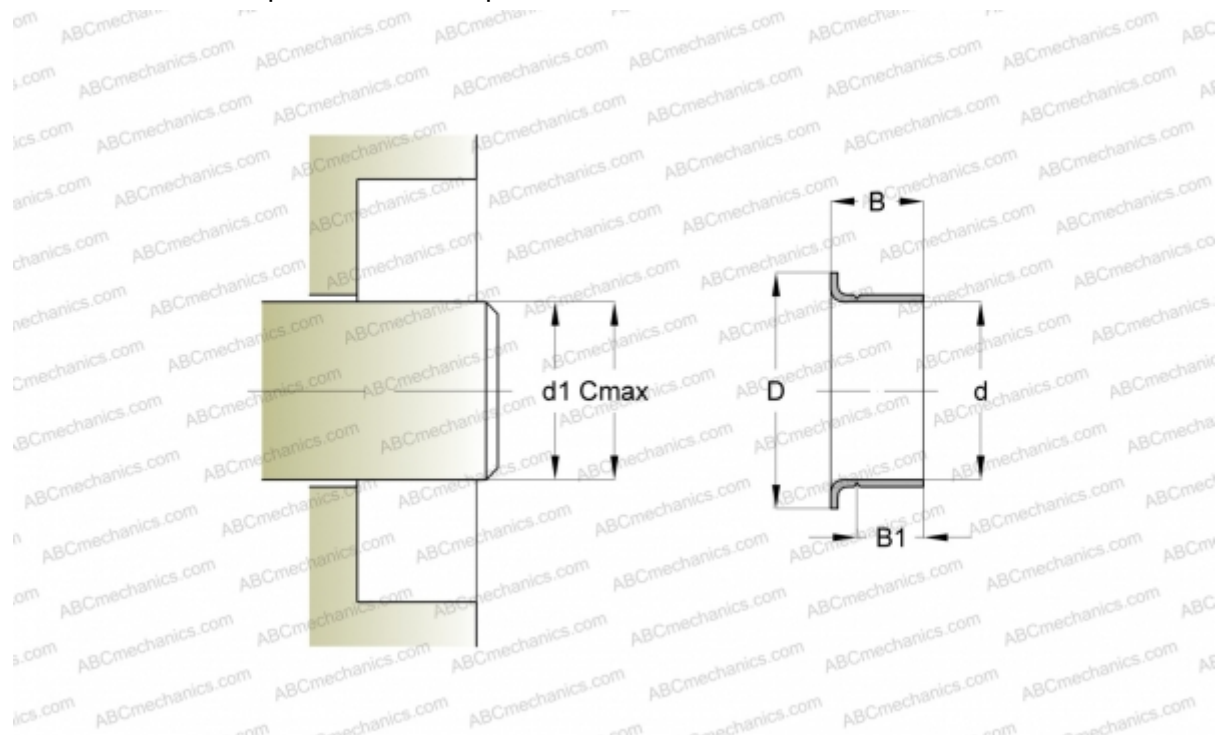

CR 99076 CR

Wear sleeves

TYPE: Wear sleeves, SKF Speedi-Sleeve, Speedi-Sleeve (SKF)



Technical specification

DIMENSIONS, MM

d1	19,000
d	19,050
D	24,000
B	11,130
B1	7,950
C	19,100

MANUFACTURER [CR](#)

INTERCHANGE

SKF	99076
-----	-----------------------

CALCULATION DATA

Maximum shaft surface speed	0,001 m/s
-----------------------------	-----------

