

99083 SKF

Wear sleeves

TYPE: Wear sleeves, SKF Speedi-Sleeve, Speedi-Sleeve (SKF)

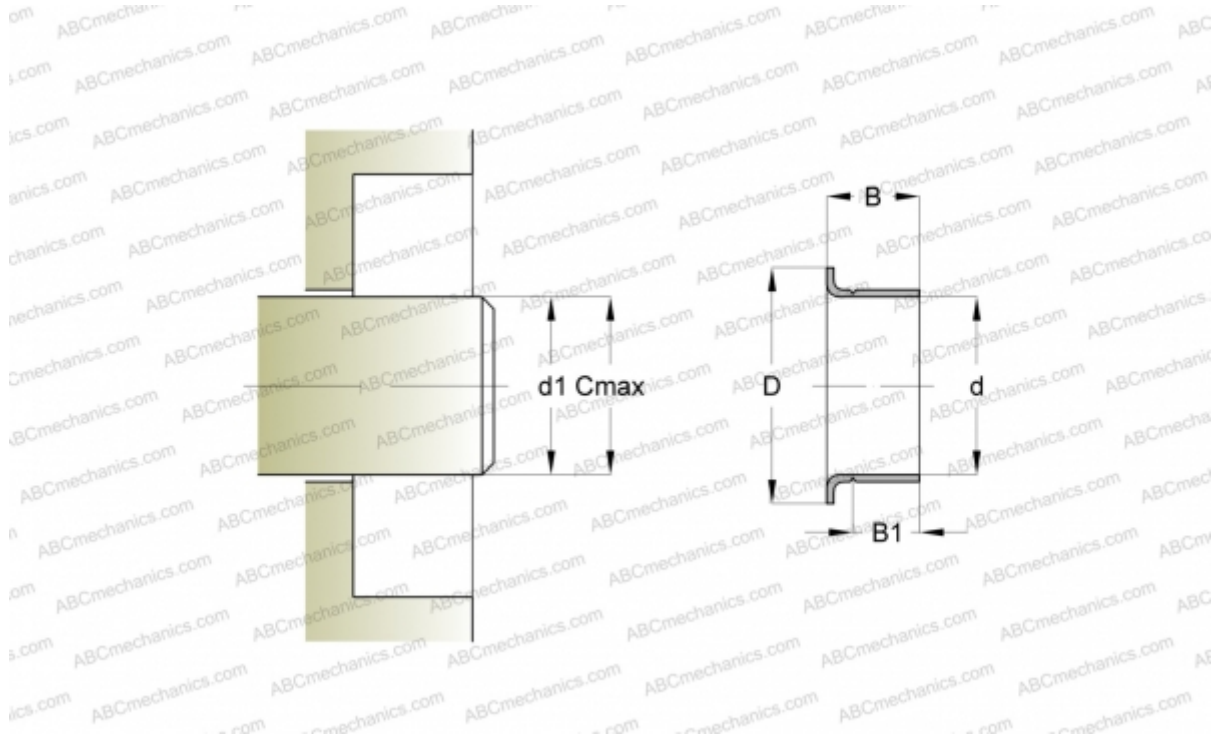

Technical specification

DIMENSIONS, MM

| | |
|----|--------|
| d1 | 20,620 |
| d | 20,650 |
| D | 30,180 |
| B | 14,300 |
| B1 | 9,530 |
| C | 20,700 |

MANUFACTURER [SKF](#)

INTERCHANGE

CR [CR 99083](#)

CALCULATION DATA

Maximum shaft surface speed 0,001 m/s