

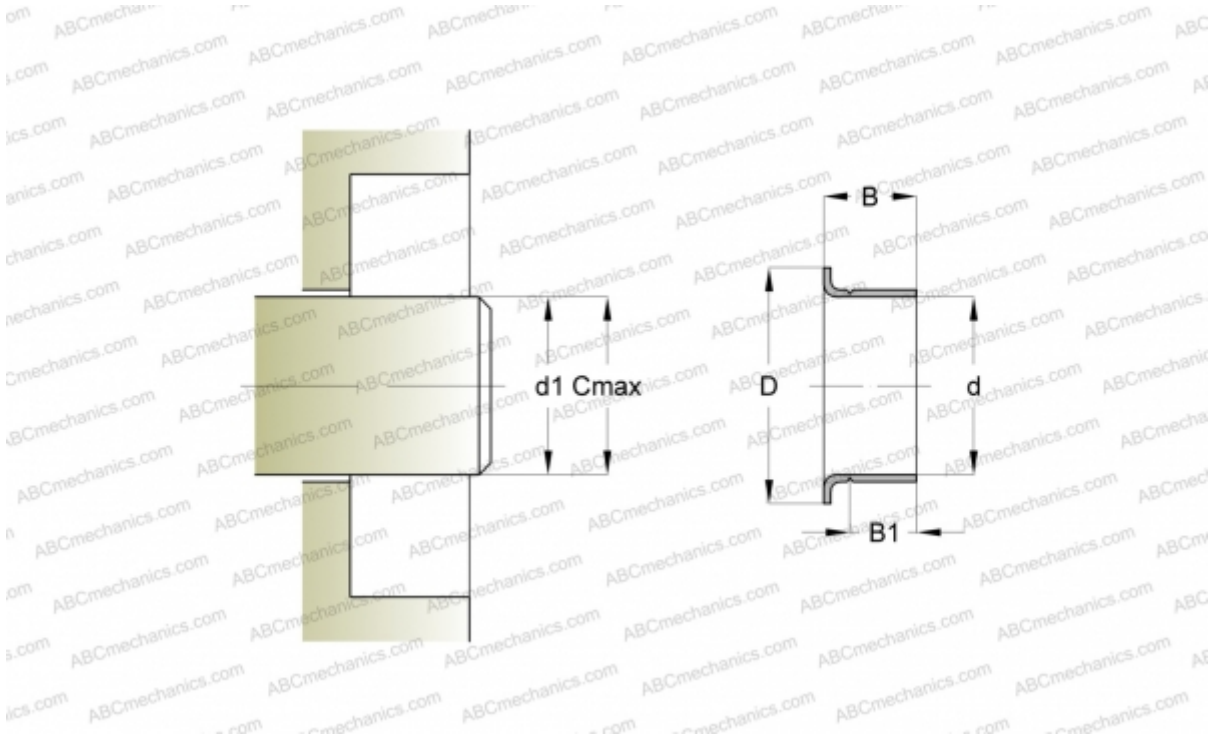

CR 99091 CR

Wear sleeves

TYPE: Wear sleeves, SKF Speedi-Sleeve, Speedi-Sleeve (SKF)



Technical specification

DIMENSIONS, MM	
d1	23,060
d	23,110
D	30,940
B	11,130
B1	7,950
C	23,160
MANUFACTURER	
CR	
INTERCHANGE	
SKF	99091
CALCULATION DATA	
Maximum shaft surface speed	0,001 m/s

