

## 99096 SKF

Wear sleeves

TYPE: Wear sleeves, SKF Speedi-Sleeve, Speedi-Sleeve (SKF)

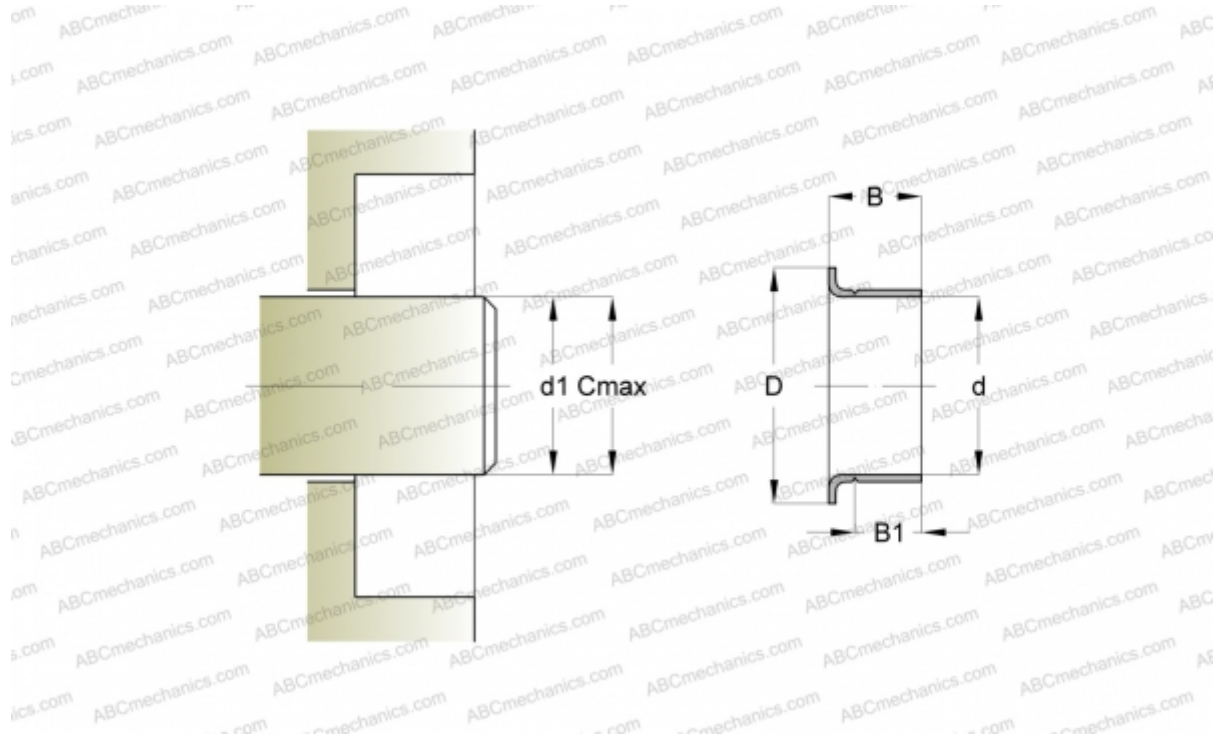

### Technical specification

#### DIMENSIONS, MM

d1	24,540
d	24,610
D	28,700
B	18,260
B1	15,880
C	24,640

**MANUFACTURER** [SKF](#)

#### INTERCHANGE

CR [CR 99096](#)

#### CALCULATION DATA

Maximum shaft surface speed 0,001 m/s