

## CR 99106 CR

Wear sleeves

TYPE: Wear sleeves, SKF Speedi-Sleeve, Speedi-Sleeve (SKF)

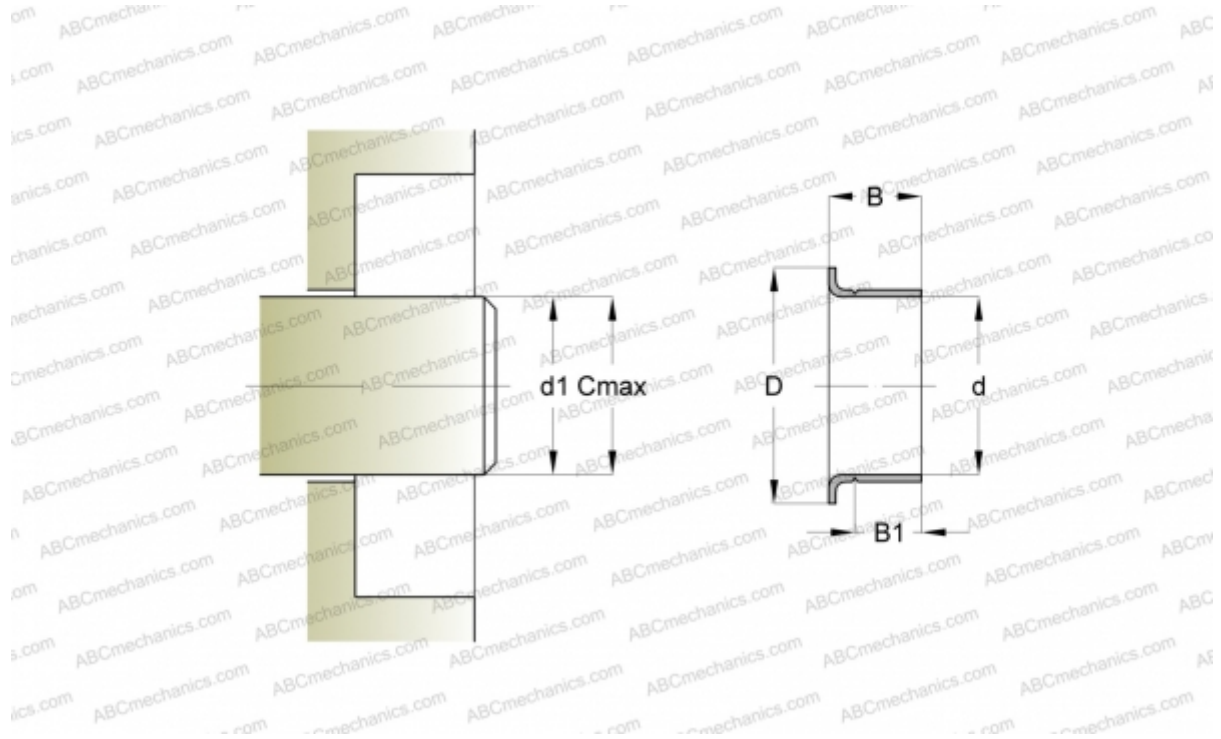

### Technical specification

#### DIMENSIONS, MM

d1	26,920
d	27,000
D	33,530
B	11,130
B1	7,950
C	27,030

**MANUFACTURER** [CR](#)

#### INTERCHANGE

SKF	<a href="#">99106</a>
-----	-----------------------

#### CALCULATION DATA

Maximum shaft surface speed	0,001 m/s
-----------------------------	-----------