

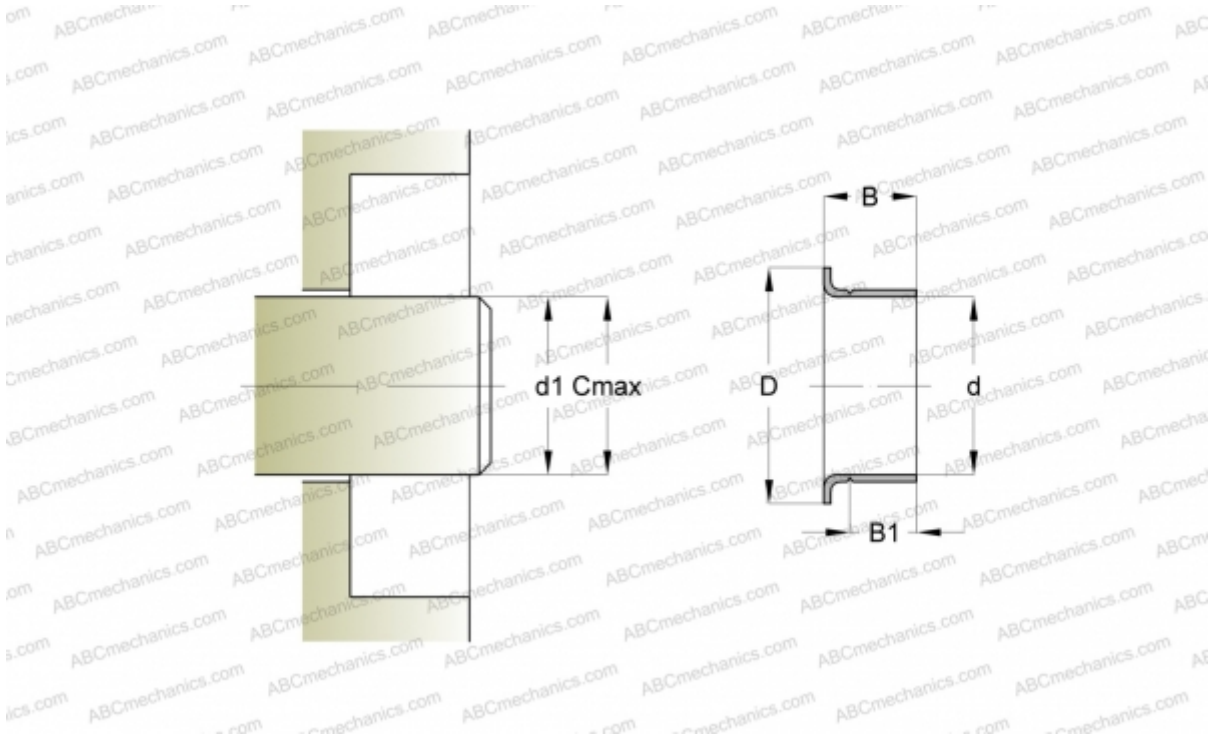

CR 99116 CR

Wear sleeves

TYPE: Wear sleeves, SKF Speedi-Sleeve, Speedi-Sleeve (SKF)



Technical specification

DIMENSIONS, MM

d1	28,520
d	28,580
D	38,100
B	12,700
B1	9,530
C	28,630

MANUFACTURER [CR](#)

INTERCHANGE

SKF	99116
-----	-----------------------

CALCULATION DATA

Maximum shaft surface speed	0,001 m/s
-----------------------------	-----------

