

## 99125 SKF

Wear sleeves

TYPE: Wear sleeves, SKF Speedi-Sleeve, Speedi-Sleeve (SKF)

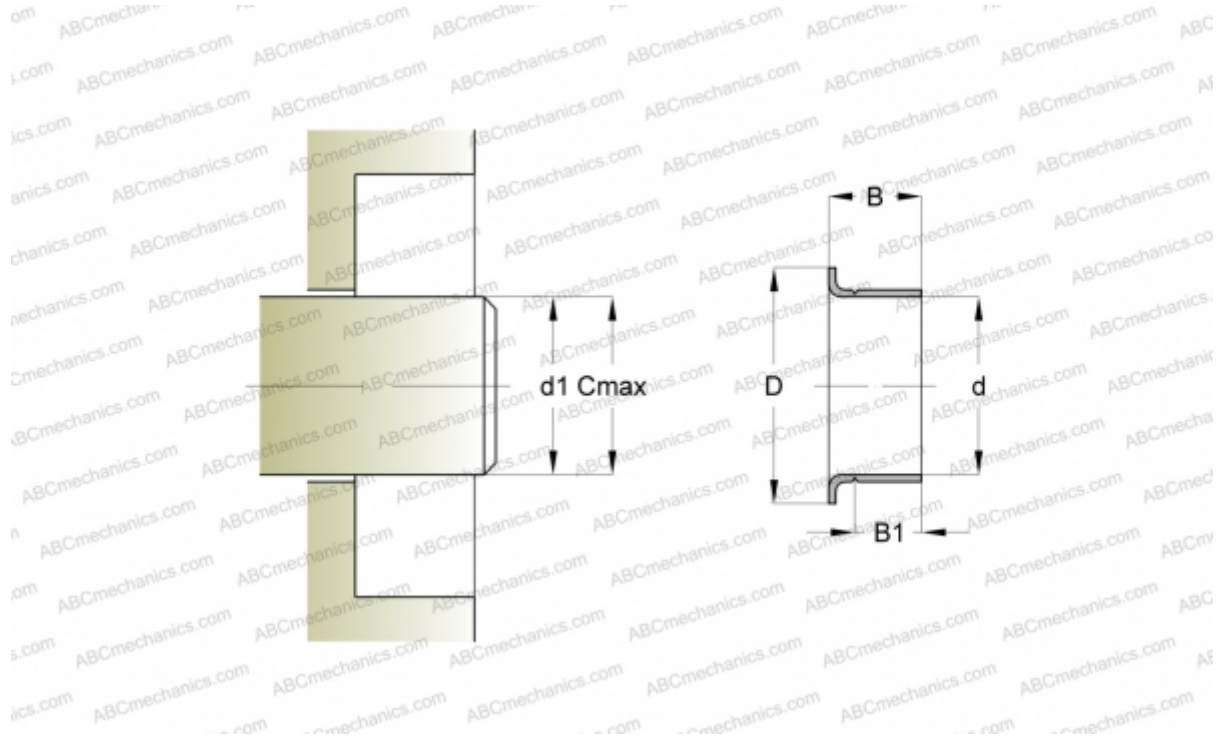

### Technical specification

#### DIMENSIONS, MM

d1	31,670
d	31,750
D	38,100
B	11,130
B1	7,950
C	31,830

**MANUFACTURER** [SKF](#)

#### INTERCHANGE

CR [CR 99125](#)

#### CALCULATION DATA

Maximum shaft surface speed 0,001 m/s