

## CR 99121 CR

Wear sleeves

TYPE: Wear sleeves, SKF Speedi-Sleeve, Speedi-Sleeve (SKF)

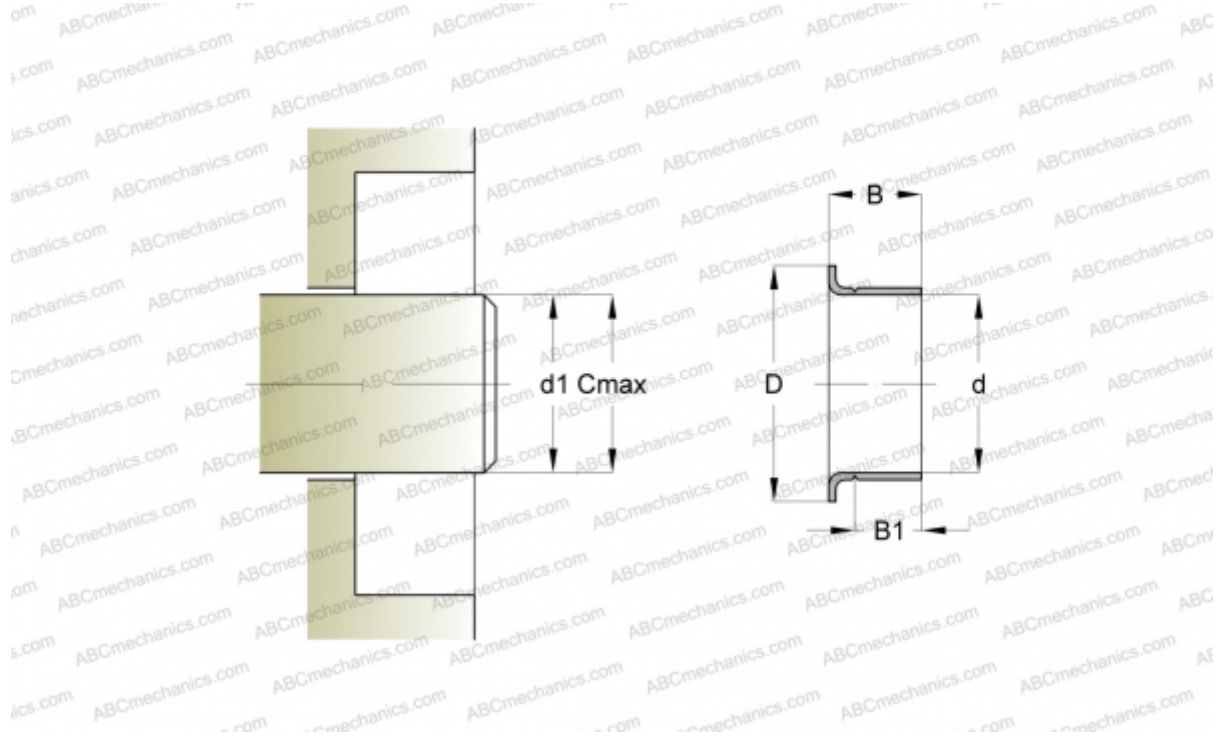

### Technical specification

#### DIMENSIONS, MM

d1	32,940
d	32,990
D	40,490
B	18,010
B1	15,010
C	33,050

**MANUFACTURER** [CR](#)

#### INTERCHANGE

SKF [99121](#)

#### CALCULATION DATA

Maximum shaft surface speed 0,001 m/s