

99134 SKF

Wear sleeves

TYPE: Wear sleeves, SKF Speedi-Sleeve, Speedi-Sleeve (SKF)

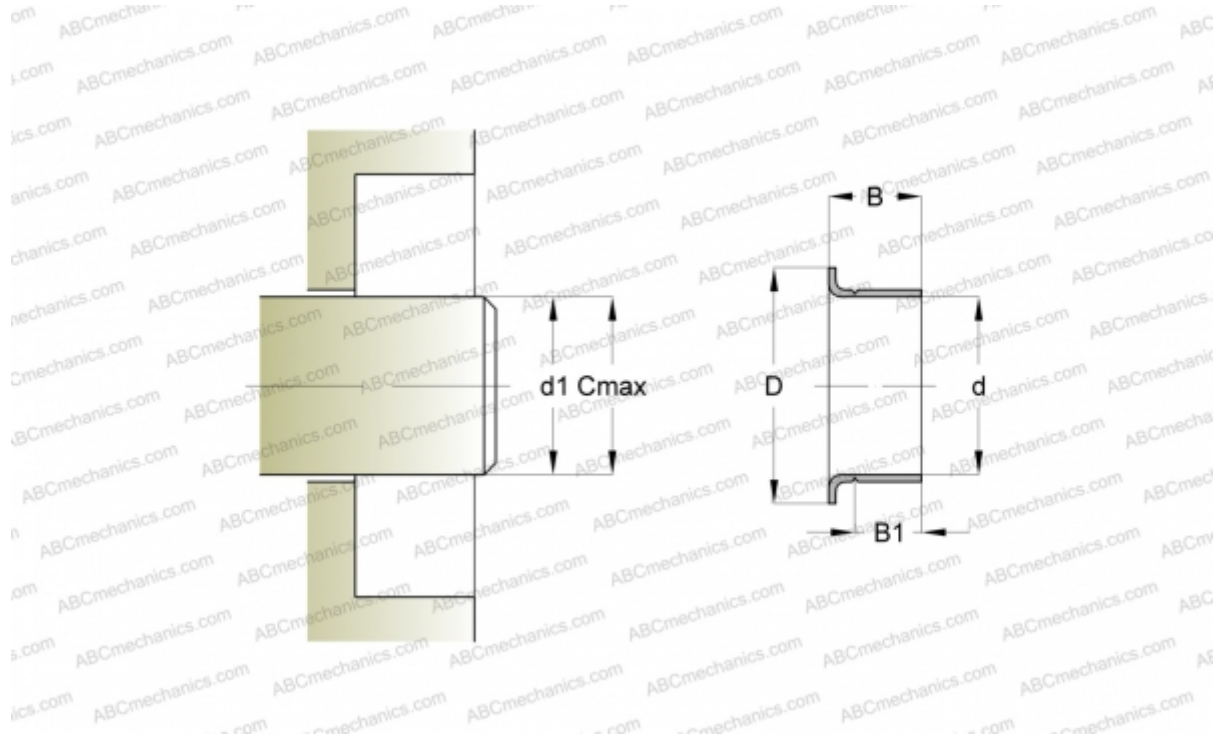

Technical specification

DIMENSIONS, MM

d1	33,860
d	34,010
D	41,280
B	15,880
B1	12,700
C	34,010

MANUFACTURER [SKF](#)

INTERCHANGE

CR [CR 99134](#)

CALCULATION DATA

Maximum shaft surface speed 0,001 m/s