

99139 SKF

Wear sleeves

TYPE: Wear sleeves, SKF Speedi-Sleeve, Speedi-Sleeve (SKF)

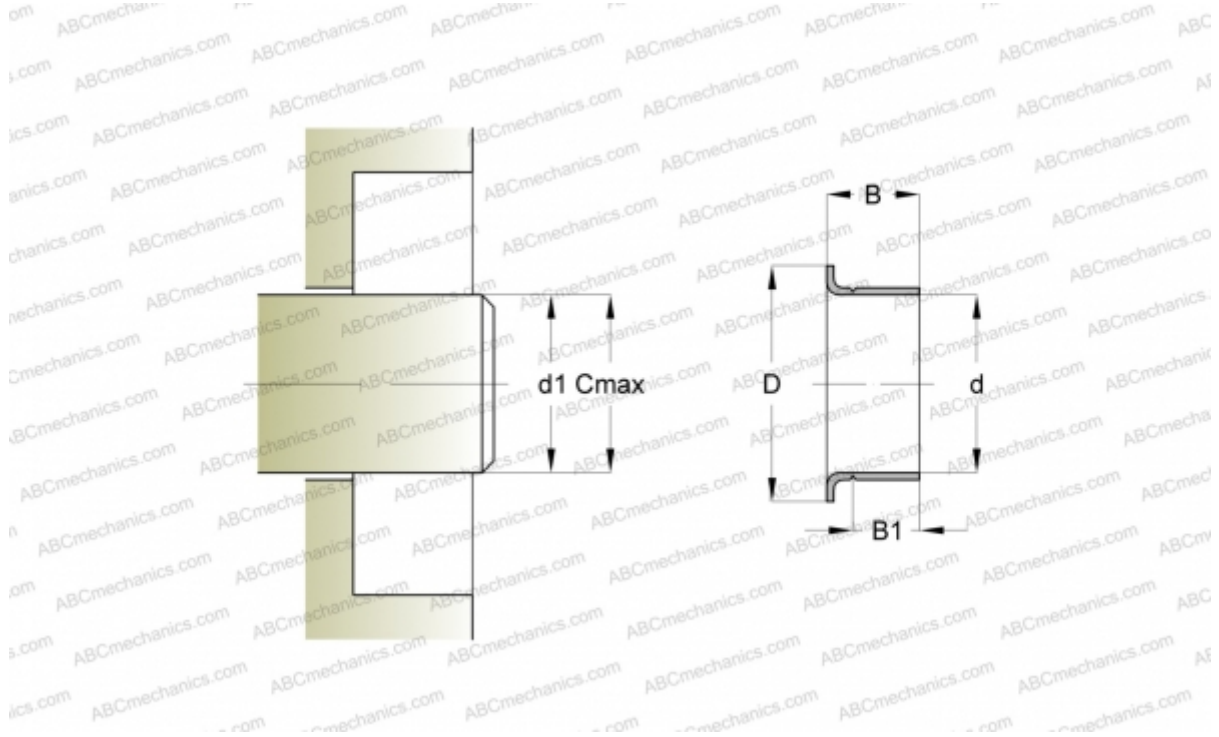

Technical specification

DIMENSIONS, MM

d1	34,930
d	34,930
D	41,610
B	16,000
B1	13,000
C	35,080

MANUFACTURER [SKF](#)

INTERCHANGE

CR [CR 99139](#)

CALCULATION DATA

Maximum shaft surface speed 0,001 m/s