

CR 99147 CR

Wear sleeves

TYPE: Wear sleeves, SKF Speedi-Sleeve, Speedi-Sleeve (SKF)

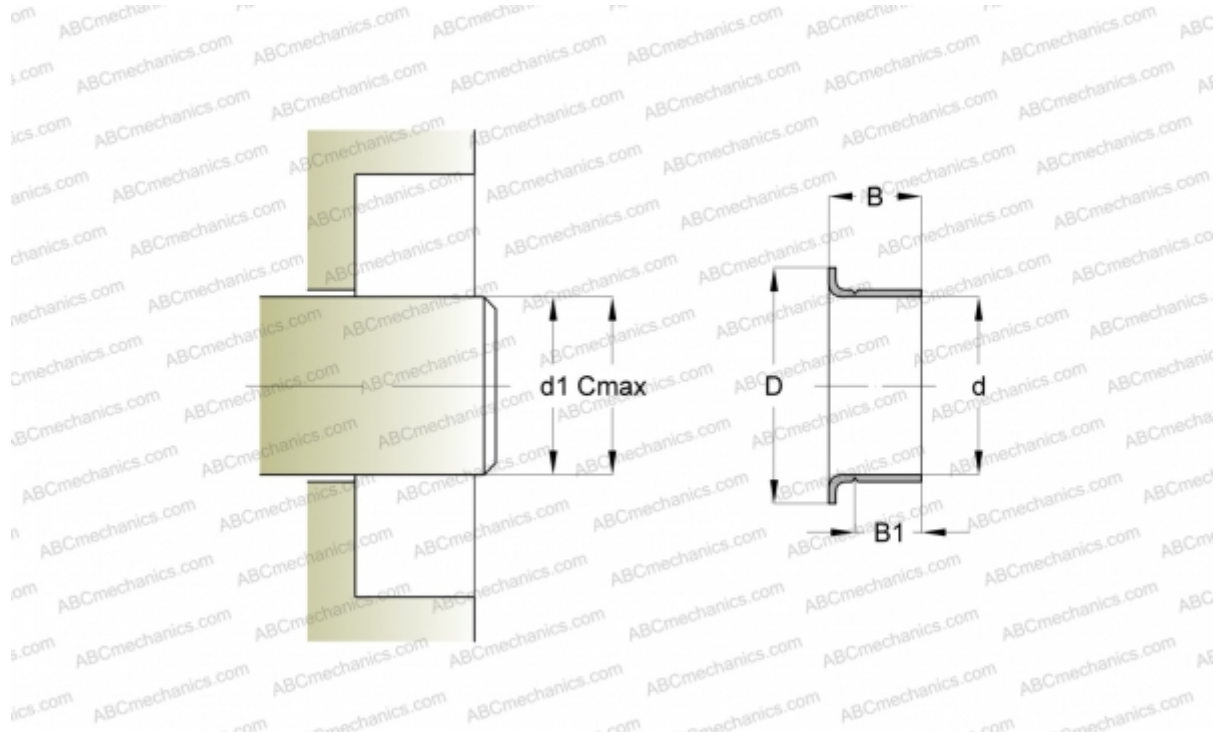

Technical specification

DIMENSIONS, MM

d1	37,850
d	38,000
D	45,240
B	16,990
B1	13,000
C	38,000

MANUFACTURER

[CR](#)

INTERCHANGE

SKF	99147
-----	-----------------------

CALCULATION DATA

Maximum shaft surface speed	0,001 m/s
-----------------------------	-----------