

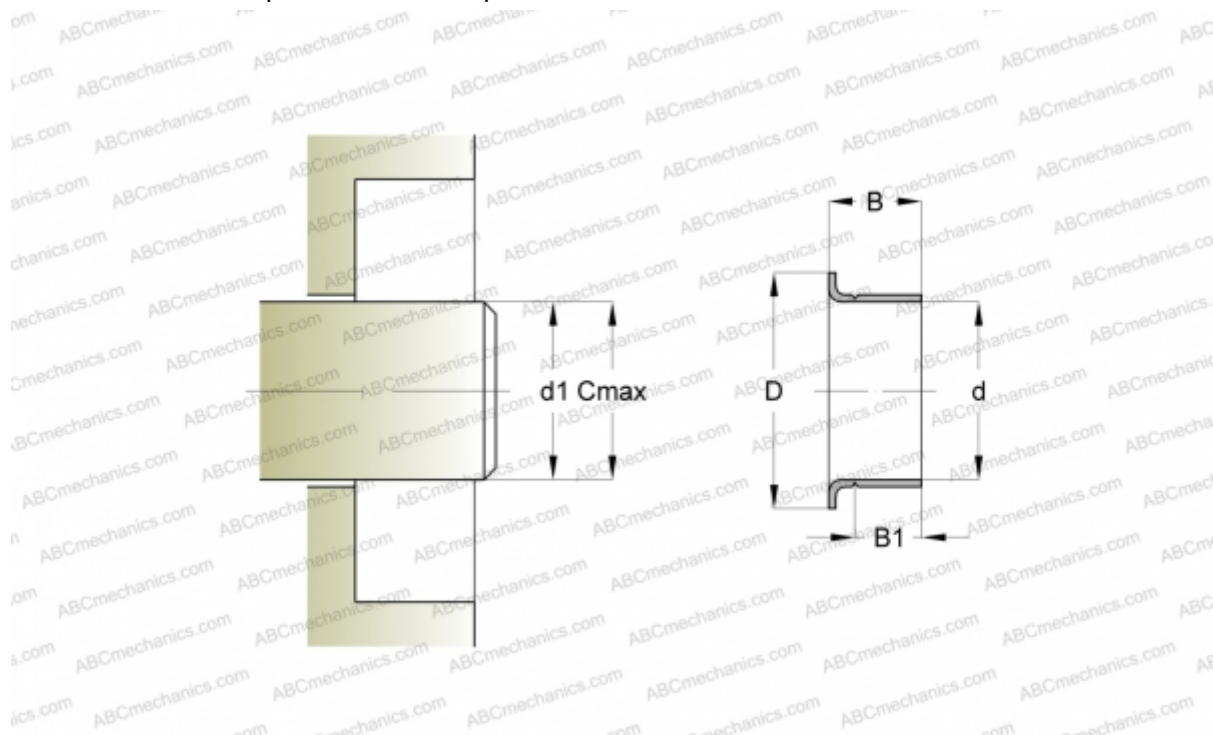

CR 99163 CR

Wear sleeves

TYPE: Wear sleeves, SKF Speedi-Sleeve, Speedi-Sleeve (SKF)



Technical specification

DIMENSIONS, MM

d1	40,840
d	41,000
D	49,230
B	15,880
B1	12,700
C	41,000

MANUFACTURER

[CR](#)

INTERCHANGE

SKF	99163
-----	-----------------------

CALCULATION DATA

Maximum shaft surface speed	0,001 m/s
-----------------------------	-----------

