

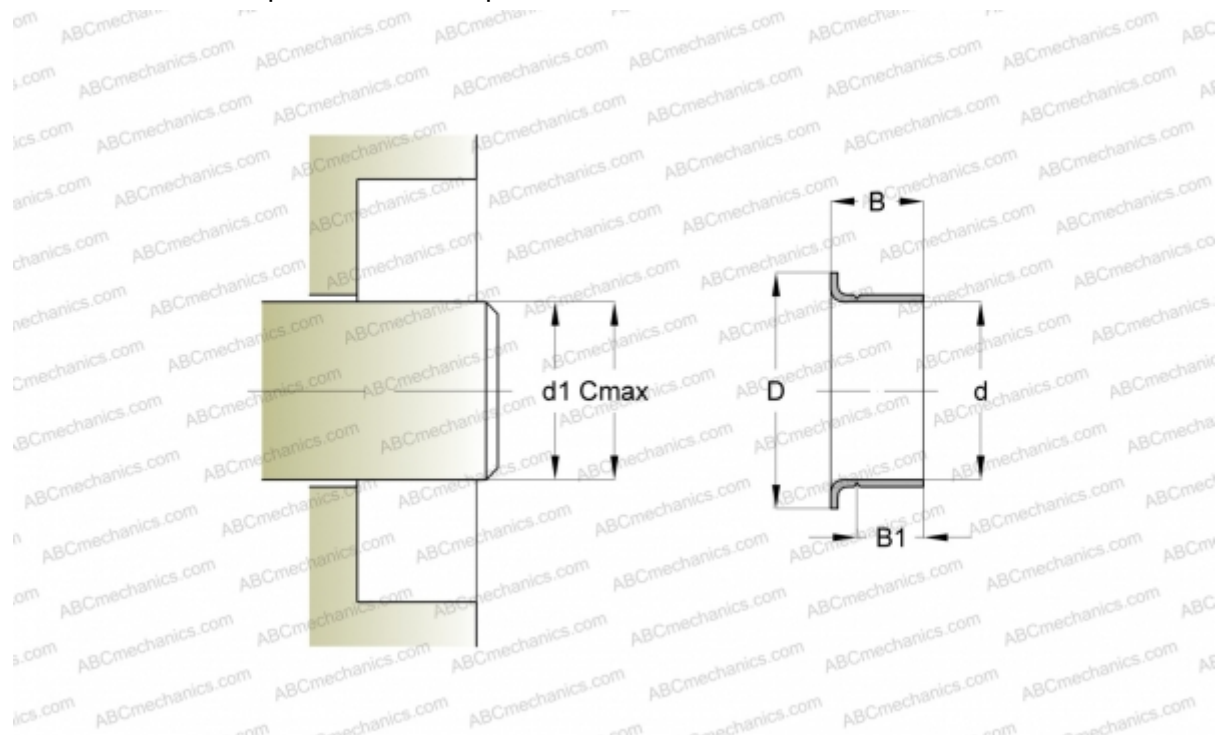

## CR 99169 CR

Wear sleeves

TYPE: Wear sleeves, SKF Speedi-Sleeve, Speedi-Sleeve (SKF)



### Technical specification

#### DIMENSIONS, MM

d1	41,830
d	41,910
D	53,010
B	17,500
B1	14,300
C	42,010

MANUFACTURER [CR](#)

#### INTERCHANGE

SKF	<a href="#">99169</a>
-----	-----------------------

#### CALCULATION DATA

Maximum shaft surface speed	0,001 m/s
-----------------------------	-----------

