

## 99170 SKF

Wear sleeves

TYPE: Wear sleeves, SKF Speedi-Sleeve, Speedi-Sleeve (SKF)

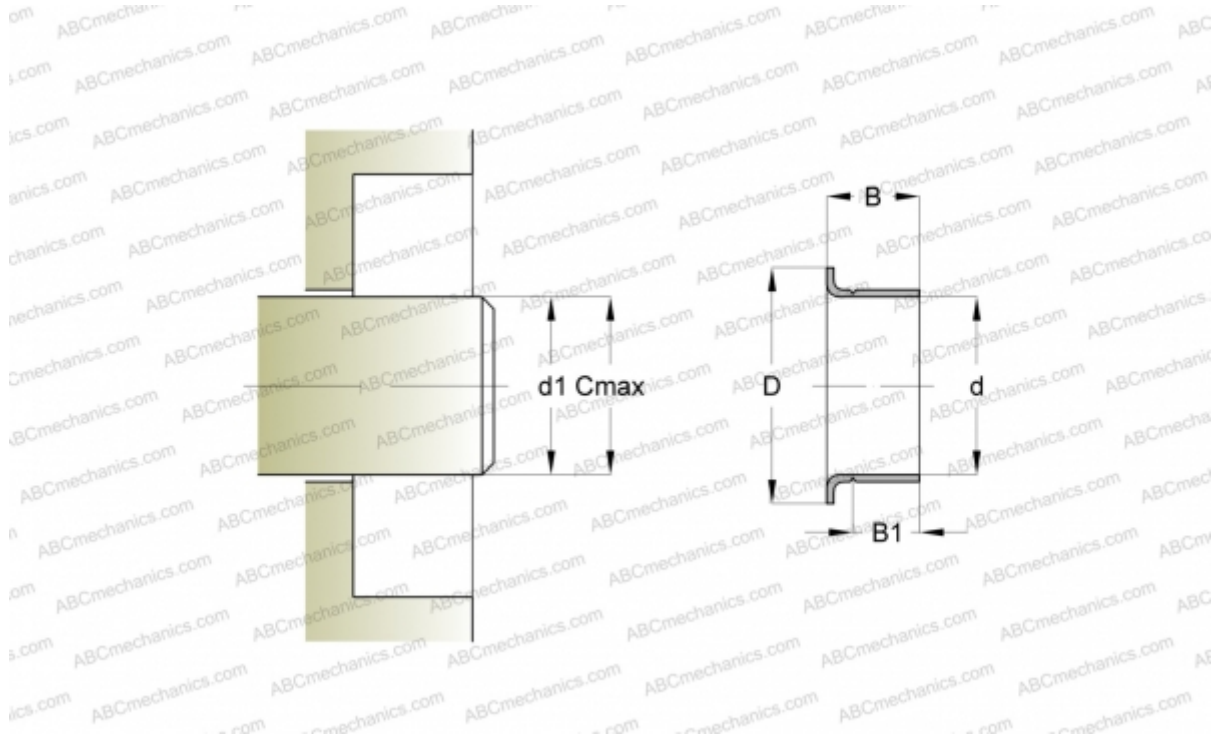

### Technical specification

#### DIMENSIONS, MM

d1	44,090
d	44,170
D	52,400
B	12,700
B1	9,530
C	44,250

**MANUFACTURER** [SKF](#)

#### INTERCHANGE

CR [CR 99170](#)

#### CALCULATION DATA

Maximum shaft surface speed 0,001 m/s