

## 99174 SKF

Wear sleeves

TYPE: Wear sleeves, SKF Speedi-Sleeve, Speedi-Sleeve (SKF)

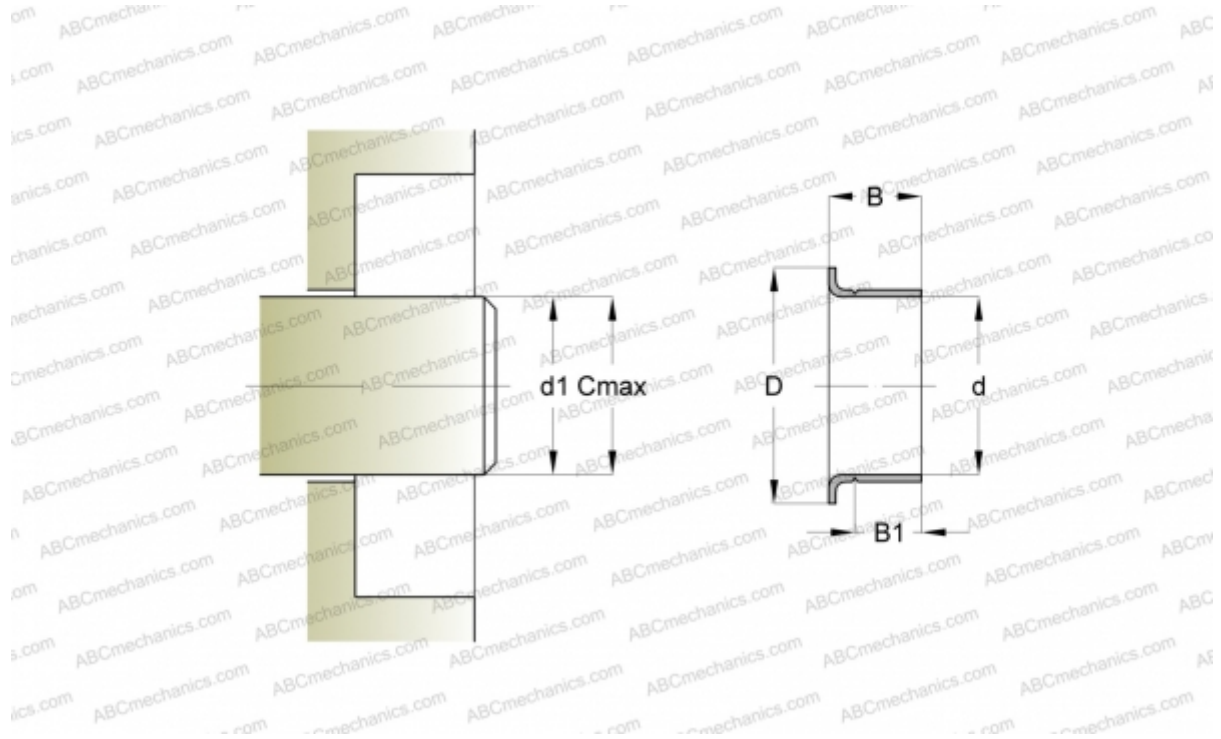

### Technical specification

#### DIMENSIONS, MM

d1	44,370
d	44,450
D	52,400
B	17,480
B1	14,300
C	44,530

#### MANUFACTURER

[SKF](#)

#### INTERCHANGE

CR	<a href="#">CR 99174</a>
----	--------------------------

#### CALCULATION DATA

Maximum shaft surface speed	0,001 m/s
-----------------------------	-----------