

99189 SKF

Wear sleeves

TYPE: Wear sleeves, SKF Speedi-Sleeve, Speedi-Sleeve (SKF)

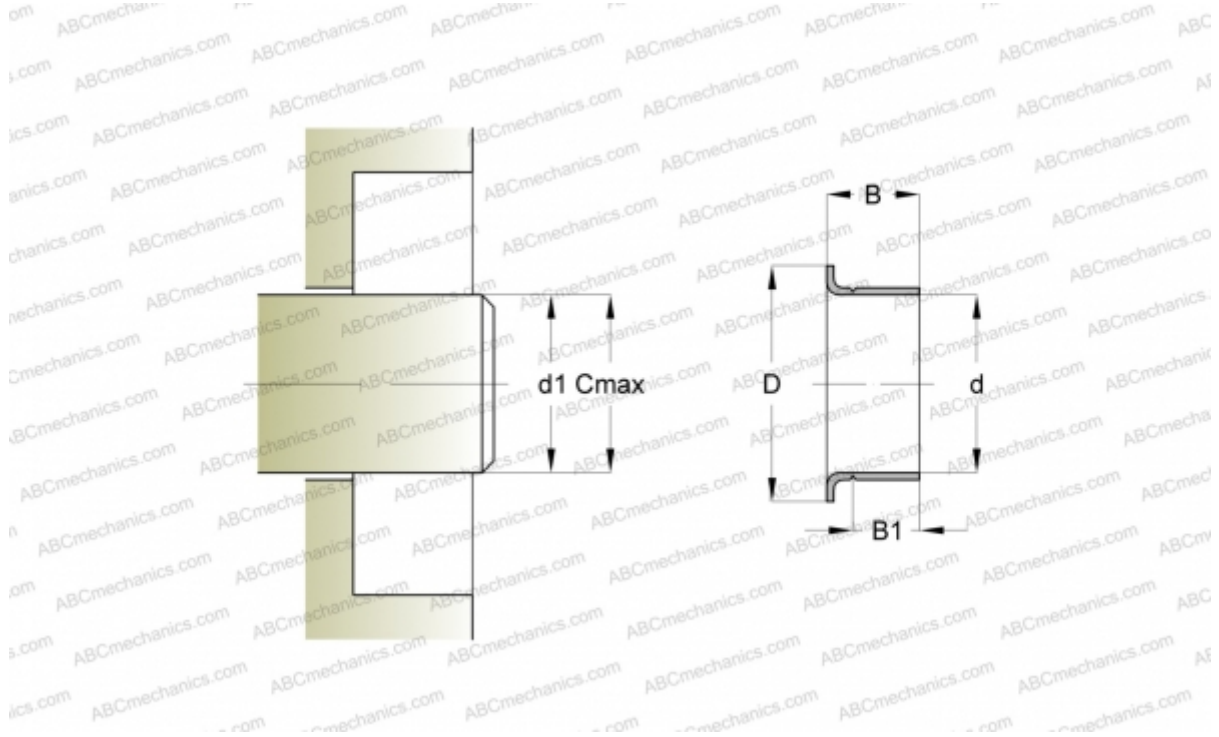

Technical specification

DIMENSIONS, MM

d1	47,930
d	48,030
D	56,010
B	16,970
B1	14,000
C	48,080

MANUFACTURER [SKF](#)

INTERCHANGE

CR [CR 99189](#)

CALCULATION DATA

Maximum shaft surface speed 0,001 m/s