

## 99878 SKF

Wear sleeves

TYPE: Wear sleeves, SKF Speedi-Sleeve, Speedi-Sleeve (SKF)

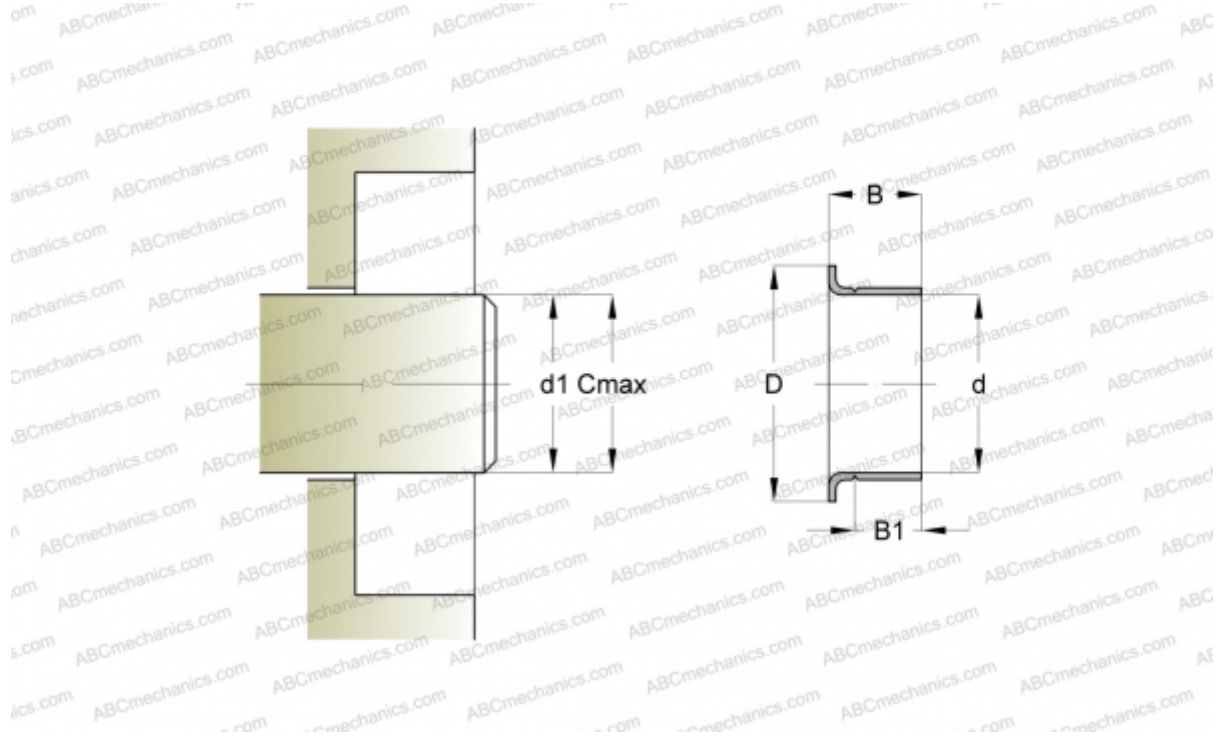

### Technical specification

#### DIMENSIONS, MM

d1	51,820
d	51,990
D	62,710
B	15,880
B1	12,700
C	51,990

**MANUFACTURER** [SKF](#)

#### INTERCHANGE

CR [CR 99878](#)

#### CALCULATION DATA

Maximum shaft surface speed 0,001 m/s