

CR 99205 CR

Wear sleeves

TYPE: Wear sleeves, SKF Speedi-Sleeve, Speedi-Sleeve (SKF)

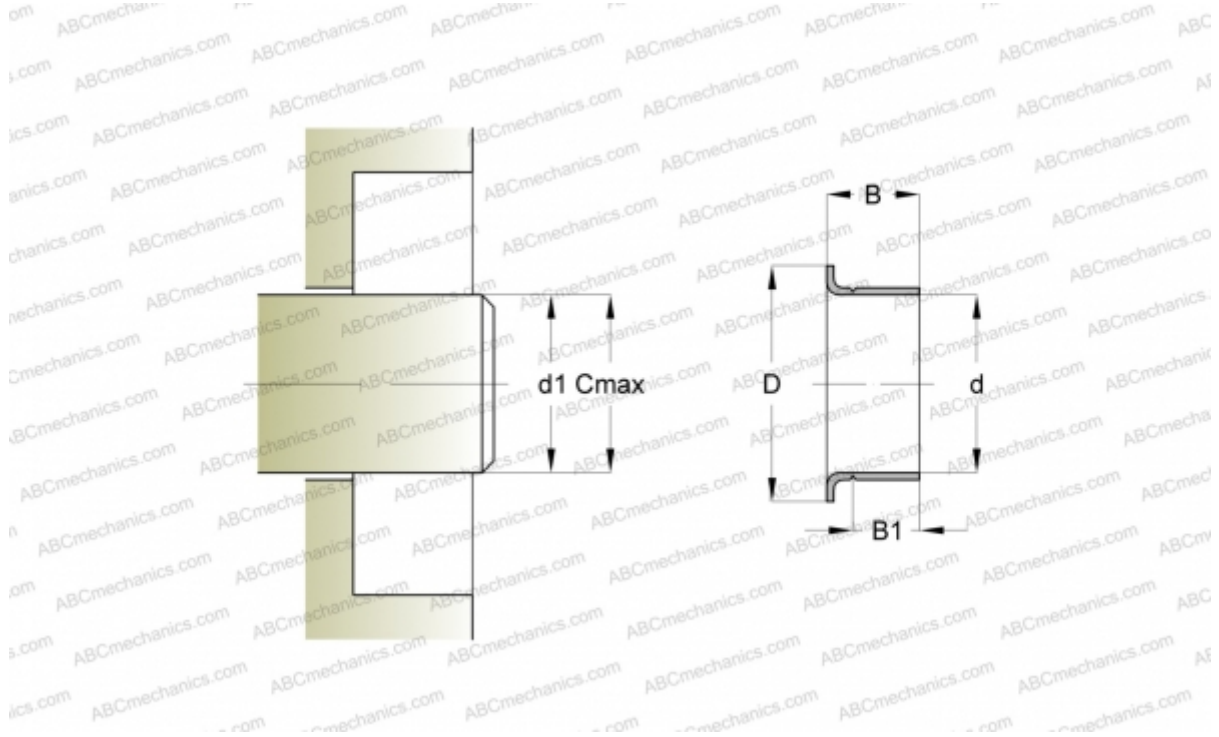

Technical specification

DIMENSIONS, MM

| | |
|----|--------|
| d1 | 52,250 |
| d | 52,400 |
| D | 62,710 |
| B | 23,830 |
| B1 | 19,840 |
| C | 52,400 |

MANUFACTURER [CR](#)

INTERCHANGE

SKF [99205](#)

CALCULATION DATA

Maximum shaft surface speed 0,001 m/s