

## CR 99210 CR

Wear sleeves

TYPE: Wear sleeves, SKF Speedi-Sleeve, Speedi-Sleeve (SKF)

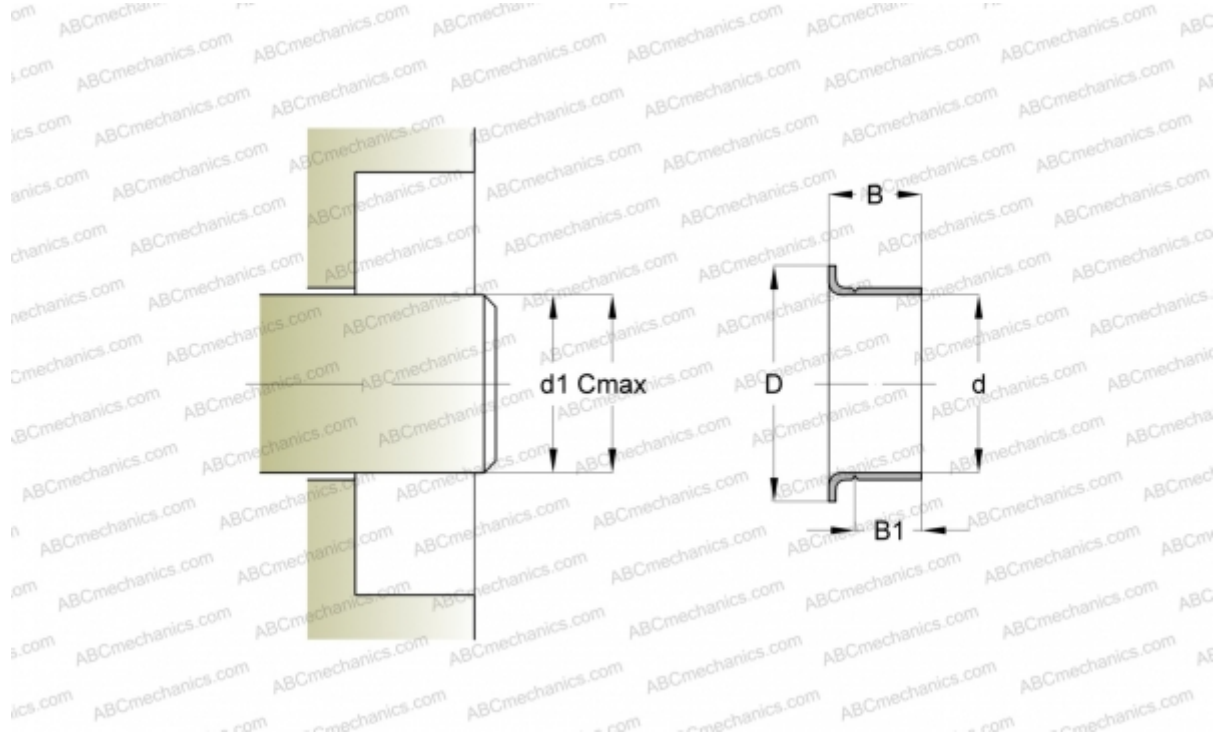

### Technical specification

#### DIMENSIONS, MM

d1	53,920
d	53,980
D	61,520
B	19,050
B1	12,700
C	54,050

**MANUFACTURER** [CR](#)

#### INTERCHANGE

SKF [99210](#)

#### CALCULATION DATA

Maximum shaft surface speed 0,001 m/s